



HAL
open science

International trade, product quality and food standards

Alessandro Olper, Karine Latouche

► **To cite this version:**

Alessandro Olper, Karine Latouche. International trade, product quality and food standards. 30. International conference of agricultural economists, International Association of Agricultural Economists (IAAE). INT., Jul 2018, Vancouver, Canada. hal-02787545

HAL Id: hal-02787545

<https://hal.inrae.fr/hal-02787545v1>

Submitted on 5 Jun 2020

HAL is a multi-disciplinary open access archive for the deposit and dissemination of scientific research documents, whether they are published or not. The documents may come from teaching and research institutions in France or abroad, or from public or private research centers.

L'archive ouverte pluridisciplinaire **HAL**, est destinée au dépôt et à la diffusion de documents scientifiques de niveau recherche, publiés ou non, émanant des établissements d'enseignement et de recherche français ou étrangers, des laboratoires publics ou privés.



ICAE

VANCOUVER 2018

**New Landscapes
and New Mandates
for Agriculture**

**30th INTERNATIONAL CONFERENCE OF
AGRICULTURAL ECONOMISTS**

JULY 28 - AUGUST 2
VANCOUVER, CANADA

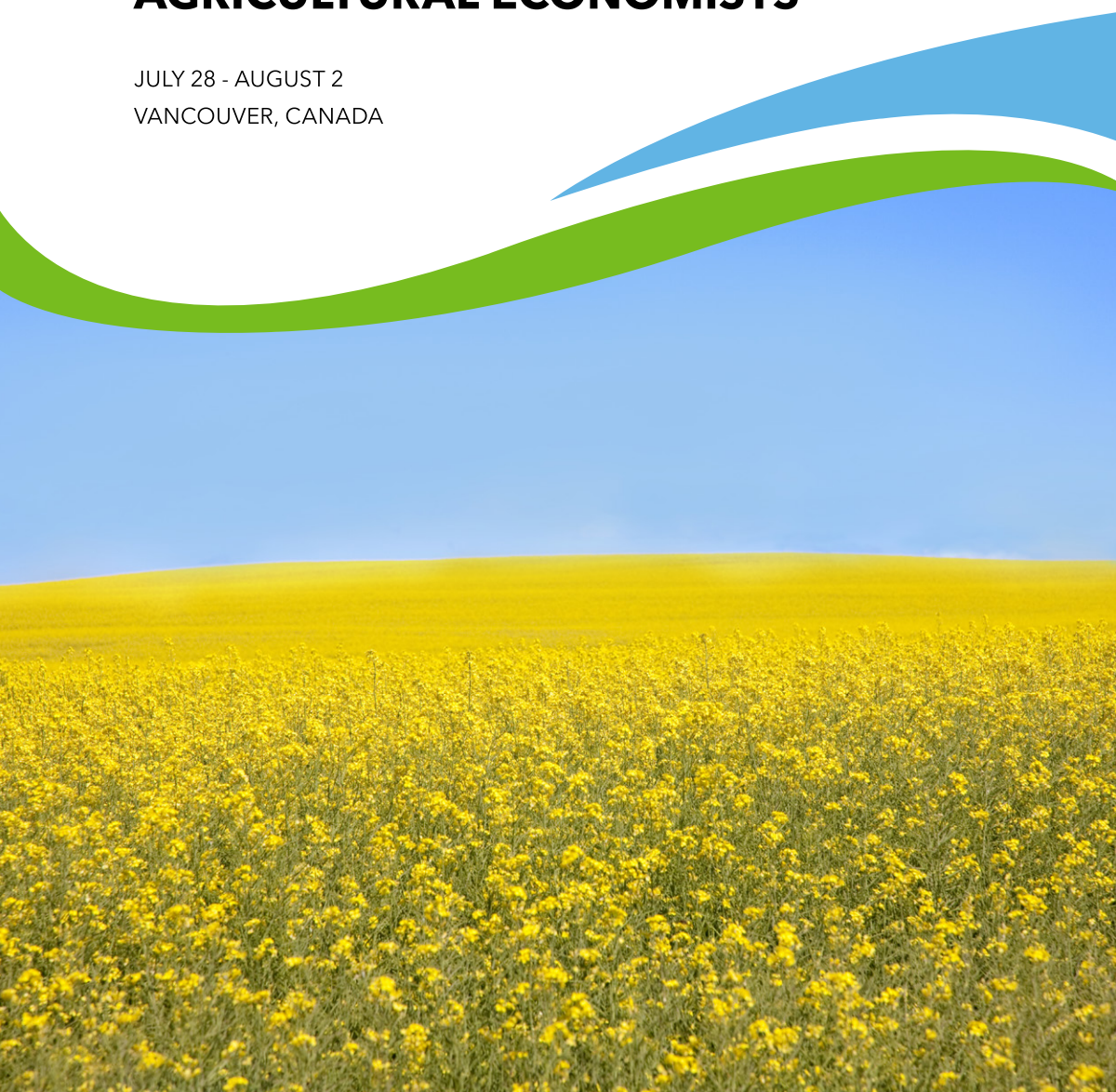

World Food Assistance 2018

Preventing Food Crises

This global report focuses on food crises, and asks what causes them to break out, what determines their scale and how they might be prevented.

For more information see wfp.org/wofa2018 | #WoFA2018



Welcome to Canada

FROM THE CHAIR OF THE LOCAL ORGANISING COMMITTEE IN CANADA



Dear Delegates and Participants,

Welcome to the 30th International Conference of Agricultural Economists in Vancouver. The Local Organising Committee in Canada (LOCC) is proud to host the first ICAE in Canada in almost 40 years - Canada last hosted the ICAE in Banff in 1979.

First, I would like to acknowledge that our event takes place on the traditional, ancestral, and unceded territory of the Musqueam people.

Vancouver is a great city. The large cosmopolitan metropolitan area is surrounded by the Pacific Ocean to the west, mountains to the north, agricultural land to the east, and the US to the south. Vancouver hosts a major port with numerous grain, oilseed, and cargo terminals, and near to the city are major agricultural and food processing areas for dairy, poultry, fruit, and vegetables. Ocean fishing and aquaculture are important in the local economy. Further inland is the picturesque Okanagan Valley, with vineyards and wineries, and fruit and vegetable areas surrounding Okanagan Lake.

British Columbia has major resource industries: forestry, mining, fishing and shellfish (e.g. salmon), and energy. The province is fertile ground for the study of resource and environmental markets and policy issues. Vancouver is home to two renowned universities, the University of British Columbia and Simon Fraser University.

Vancouver hosted the 2010 Winter Olympics, offers a wide range of hotels and conference facilities, and excellent public transit around the city, including from the airport to downtown. Visitors to Vancouver can enjoy the world-class Museum of Anthropology on the UBC Campus where the cultural history and material artifacts of the indigenous peoples of the North-West, such as the Haida, are highlighted.

The 30th academic programme of the ICAE, titled "New Landscapes and New Mandates for Agriculture", was organised by Nick Vink of Stellenbosch University. The programme features outstanding plenary speakers, invited panels, and a terrific mix of oral and visual presentations. The conference tours on Tuesday July 31 feature some of the region's most interesting attractions related to food, agricultural, and resource economics.

We hope that you enjoy the ICAE. If you have questions or concerns please ask one of our local organising committee members (names are listed in the conference programme) or one of our student volunteers, who will be on site at the Westin and accompanying the offsite tours.

Sincerely,

Ryan Cardwell
Chair, Local Organising Committee in Canada

TABLE OF CONTENTS

6	Programme at a glance
10	Conference Committees
12	Volunteers
13	Sponsors
14	General Information
22	Floor Plan
24	Speakers Information
27	Awards
28	Keynote Speakers
55	Scientific Programme



PROGRAMME AT A GLANCE

SATURDAY JULY 28	
08:30 - 17:00	Pre-Conference Workshops
SUNDAY JULY 29	
08:30 - 10:30	PLENARY 1 Welcome and Opening Session Formal Opening and Elmhirst Memorial Address
10:30 - 11:00	Tea / Coffee
11:00 - 13:00	INVITED PANELS SESSION 1 5 parallel sessions
13:00 - 14:00	Lunch
14:00 - 16:00	PARALLEL SESSIONS 1 12 parallel Oral Contributed Paper sessions 6 parallel Organized Symposia 4 parallel Visual Contributed Paper sessions
16:00 - 16:30	Tea / Coffee
16:30 - 18:30	PARALLEL SESSIONS 2 12 parallel Oral Contributed Paper sessions 6 parallel Organized Symposia 4 parallel Visual Contributed Paper sessions
18:30 - 19:30	IAAE Business Meeting
19:30	SOCIAL SESSION 1 Welcome and Opening Reception

MONDAY JULY 30	
08:00 - 10:00	PLENARY 2 Agricultural technology – The data revolution
10:00 - 10:30	Tea / Coffee
10:30 - 12:30	INVITED PANELS SESSION 2 6 parallel sessions
12:30 - 13:30	Lunch

PROGRAMME AT A GLANCE

MONDAY JULY 30 (CONT'D)	
13:30 - 15:30	PARALLEL SESSIONS 3 11 parallel Oral Contributed Paper sessions 6 parallel Organized Symposia 4 parallel Visual Contributed Paper sessions
15:30 - 16:00	Tea / Coffee
16:00 - 17:00	PARALLEL SESSIONS 4 18 parallel Oral Contributed Paper sessions
17:30 - 19:30	PLENARY 3 The future of food systems in developing countries
20:30 - 21:30	MOVIE SCREENING - "Food Evolution"

TUESDAY JULY 31	
08:00 - 10:00	PARALLEL SESSIONS 5 12 parallel Oral Contributed Paper sessions 6 parallel Organized Symposia 4 parallel Visual Contributed Paper sessions
10:00 - 10:30	Tea / Coffee
10:30 - 18:00	Conference Tours
19:30	SOCIAL SESSION 2 Offsite dinner at the Vancouver Aquarium

WEDNESDAY AUGUST 1	
08:30 - 10:30	PLENARY 4 New landscapes and challenges amidst Africa's rapidly transforming food systems
10:30 - 11:00	Tea / Coffee
11:00 - 13:00	PARALLEL SESSIONS 6 12 parallel Oral Contributed Paper sessions 6 parallel Organized Symposia 4 parallel Visual Contributed Paper sessions
13:00 - 14:00	Lunch



PROGRAMME AT A GLANCE

WEDNESDAY AUGUST 1 (CONT'D)	
14:00 - 16:00	PLENARY 5 Producing more with less: Agriculture, land use and ecosystems
16:00 - 16:30	Tea / Coffee
16:30 - 18:30	PARALLEL SESSIONS 7 12 parallel Oral Contributed Paper sessions 6 parallel Organized Symposia 4 parallel Visual Contributed Paper sessions

THURSDAY AUGUST 2	
08:30 - 10:30	PLENARY 6 Insights from a behavioural lens: Why perceptions and diversity matter
10:30 - 11:00	Tea / Coffee
11:00 - 13:00	INVITED PANELS SESSION 3 6 parallel sessions
13:00 - 14:00	Lunch
14:00 - 15:20	PARALLEL SESSIONS 8 12 parallel Oral Contributed Paper sessions 4 parallel Organized Symposia
15:20 - 15:50	Tea / Coffee
15:50 - 18:10	PLENARY 7 Upgraded Papers Uma Lele Award Nils Westermarck Award TW Schultz Award
18:10 - 18:30	CLOSING CEREMONY
19:30	SOCIAL SESSION 3 Conference Dinner



Economic Research Service

The U.S. Department of Agriculture's Economic Research Service (ERS) anticipates trends and emerging issues in agriculture, food, the environment, and rural America and conducts high-quality, objective economic research to inform and enhance public and private decision making.

ERS research and analysis covers a broad range of economic and policy topics:

Agricultural Economy

Farm sector performance and farm households' well-being; farm size and concentration; market analysis, data, and projections on commodity supply, demand, and prices; and U.S. farm policies

Food and Nutrition

U.S. food security, food and nutrition assistance programs, food choices and health outcomes, food access and store proximity, food retailing and marketing, and food prices

Food Safety

Societal benefits associated with reducing food safety risks, economic impacts of food hazards, and potential results of regulation versus industry decisions

Global Markets and Trade

Major markets and competitors, economic impacts of exports and imports, trade barriers, and potential trade agreements

Resources and Environment

Economic impacts of conservation programs, efficacy of policies designed to protect the environment, and enhancing agricultural competitiveness through technology

Rural Economy

Investments in rural communities and drivers of rural economic performance, demographic change and its impact on rural communities

The ERS website provides a wealth of research publications and over 70 data products and mapping tools. Some of ERS' key products include:

- **Charts of Note**
Snapshots of key ERS findings in a daily graph/chart
- **Amber Waves**
ERS' award-winning online magazine
- **Ag and Food Statistics: Charting the Essentials**
Over 75 charts and maps giving a bird's-eye-view of farms, food, rural communities, and the environment

Stay connected to ERS through our weekly e-mail service

www.ers.usda.gov/updates
or on Twitter @USDA_ERS

CONFERENCE COMMITTEES

IAAE BOARD OF DIRECTORS

President: **Will Martin**, IFPRI
President Elect: **Nick Vink**, Stellenbosch University
Past President: **Jo Swinnen**, KU Leuven
Secretary-Treasurer: **Stephan von Cramon-Taubadel**, University of Göttingen

AT LARGE MEMBERS **Julian Alston**, University of California, Davis
Karen Brooks, IFPRI
Steven Were Omamo, WFP

EDITORS OF AGRICULTURAL ECONOMICS

Awudu Abdulai, University of Kiel
Ashok Mishra, Louisiana State University

LOCAL ORGANIZING COMMITTEE

Sven Anders, University of Alberta
Richard Barichello, University of British Columbia
Lars Brink, Independent Advisor
Ryan Cardwell, University of Manitoba (Chair)
Monika Drozd, Ontario Ministry of Economic Development and Growth
Brad Gilmour, Mouralea Consulting
Douglas Hedley, Retired, Agriculture and Agri-Food Canada
Spencer Henson, University of Guelph
Matthew Hink, Agriculture and Agri-Food Canada
Jill Hobbs, University of Saskatchewan
Jennifer Vignola, Agriculture and Agri-Food Canada

PROGRAMME COMMITTEE

Nick Vink, Stellenbosch University
Jan Greyling, Stellenbosch University

CONTRIBUTED PAPERS

Colin Thirtle, Professor Emeritus, Imperial College, London
Jennifer Piesse, University of Bournemouth

ORGANIZED SESSIONS

Jerry Shively, Purdue University

CONFERENCE COMMITTEES

PRIZE COMMITTEES

T.W. Schultz Prize for Best Contributed Paper
Marijke d'Haese, University of Ghent (Convenor)
Avinash Kishore, IFPRI
Ferdi Meyer, University of Pretoria

Nils Westermarck Prize for Best Poster
Boris Bravo-Ureta, University of Connecticut
Jeff Gow, University of Southern Queensland
Jennifer Piesse, University of Bournemouth (Convenor)

Uma Lele Prize for Best Contributed Paper on Gender
Sophia Davidova, University of Kent
Agnes Quisumbing, IFPRI (Convenor)
Bhavani Shankar, SOAS, University of London

Eicher Award
Jock Anderson, Emeritus, World Bank



“One person can make a difference. I shared my research in Washington at the World Bank - that’s how much opportunity the University of Guelph makes possible.”

Edwidge Tia | Master of Science in Food Agricultural and Resource Economics
Burkina Faso, West Africa
land rights researcher, economist

uoguelph.ca/fare

UNIVERSITY OF GUELPH
ONTARIO AGRICULTURAL COLLEGE
DEPARTMENT OF FOOD, AGRICULTURAL AND RESOURCE ECONOMICS

ICAE 2018 VOLUNTEERS

Christine Bichsel, University of British Columbia
 Zoe (Shushuo) Ding, University of British Columbia
 Juan Fercovic, University of British Columbia
 Paulina Gonzalez, University of British Columbia
 Sumeet Gulati, University of British Columbia (faculty member)
 Alice Guo, University of British Columbia
 Sherry (Siru) Guo, University of British Columbia
 Zhen Hao, University of British Columbia
 Selena He, University of British Columbia
 Sean Holowaychuk, University of British Columbia
 Liam Kelly, University of Guelph
 Richard Kendon, University of British Columbia (alumnus)
 Anh Le, University of British Columbia
 Jewel Li, University of British Columbia
 Yijing Li, University of British Columbia
 Candice (Yuyao) Li, University of British Columbia
 Qianmo Lu, University of Manitoba
 Amanda Norris, University of Guelph
 Marie Nosten, University of British Columbia
 Olivier Ntwali Mulisa, University of British Columbia
 Jun Obayashi, University of British Columbia
 Omotola Olaniyan, University of Saskatchewan
 Bamidele Oni, University of British Columbia
 Debbie Adebunso Oyenuga, University of British Columbia
 Aurora Philips, University of British Columbia
 Dania Romero, University of British Columbia
 Rodrigo Santistevan, University of British Columbia
 Meike Seigner, University of British Columbia
 Cheenar Shah, University of British Columbia
 Megan Song, University of California-Davis
 Ran Sun, University of Saskatchewan
 Jenny Thomson, University of British Columbia
 Tiffany Tong, University of British Columbia
 Jiaoping (Michelle) Wang, University of British Columbia
 Michelle (Wantong) Wang, University of British Columbia
 Shuo Wang, University of Alberta
 Chelsea (Chao) Zhang, University of British Columbia
 Jessica (Jieyu) Zhang, University of British Columbia
 Tetiana Zmazhenko, University of Saskatchewan

SPONSORS OF ICAE 2018

PLATINUM



GOLD



SILVER



BRONZE



SUPPORTERS



GENERAL INFORMATION

Welcome to Vancouver

Majestic mountains, sparkling ocean, rainforests and beautiful foliage throughout all four seasons make Vancouver, BC one of the most beautiful cities in the world. Canadians are known for their friendly nature, and Vancouver's citizens take great pride in their welcoming, clean, safe streets - day or night, all year round.

Vancouver is the largest city in British Columbia, and the eighth largest municipality in Canada; the Greater Vancouver metropolitan area (which includes neighbouring cities such as Burnaby, Richmond, and Surrey) is the third largest in Canada.

In February and March of 2010, Vancouver took its place on the world's stage by hosting the 2010 Olympic and Paralympic Winter Games. The City continues to see an excellent return on investments made in the 2010 Winter Games, from sustainable community centres to public art, community involvement, and transportation infrastructure.

A cosmopolitan city right on the edge of nature, Vancouver makes it easy to combine an urban getaway with outdoor adventure. From family-friendly fun to thrill-seeking exploits; from marine exploring to mountaintop luxury, you will find plenty of things to do in Vancouver.

Vancouver is also known for its diverse culinary scene. The city's restaurants, wine bars, tasting rooms, cocktail dens, food trucks, farmer's markets and bakeries are bucket list-worthy.

For more information about what Vancouver has to offer, please visit the website: www.tourismvancouver.com

Conference General Information

CONFERENCE VENUE

The 2018 International Conference of Agricultural Economists will be held at The Westin Bayshore, Vancouver, British Columbia. The Westin Bayshore offers guests the best of both worlds: the activities and cultural events of the city, as well as a relaxing Vancouver resort experience. Enjoy views of the coastline, distant mountains, Stanley Park and easy access to things to do in Vancouver, all from one of the city's top downtown Vancouver hotels.

The Westin Bayshore is located at 1601 Bayshore Drive, Vancouver, British Columbia, V6G 2V4. Phone: +1 (604) 682-3377.

GENERAL INFORMATION

REGISTRATION

Registration Desk for ICAE 2018 will be located at the Main Building, Lobby Level of The Westin Bayshore and will be open at the following times:

- Saturday 28th July 0730 hours – 1900 hours
- Sunday 29th July 0700 hours – 1900 hours
- Monday 30th July 0700 hours – 1800 hours
- Tuesday 31st July 0700 hours – 1230 hours
- Wednesday 1st August 0730 hours – 1800 hours
- Thursday 2nd August 0730 hours – 1630 hours

Conference Delegate registration fee includes:

- Access to all conference sessions
- Access to the pre-conference Workshops on July 28th *
** Note that delegates had to pre-register to attend the workshops*
- Catering during the conference
- Welcome Reception on July 29th
- Access to tours on July 31st *
** Note that delegates had to pre-register to attend the Tours*
- Offsite Dinner on July 31st
- Conference Dinner on August 2nd

Accompanying Person registration fee includes:

- Access to all conference sessions
- Catering during the conference
- Welcome Reception on July 29th
- Access to tours on July 31st *
** Note that delegates had to pre-register to attend the Tours*
- Offsite Dinner on July 31st
- Conference Dinner on August 2nd

PLEASE NOTE THAT ACCOMPANYING PERSON'S REGISTRATION DOES NOT ALLOW THE DELEGATE TO PRESENT IN ANY SESSION.

NAME BADGES

For security purposes, delegate name badges must be worn at all times.

Accompanying Person badges will have a red band at the bottom.

Ticket for Tours and Workshops will be printed on the back of the name badge.

GENERAL INFORMATION

DRESS CODE

Business casual

PERSONAL PROPERTY

The participants are encouraged to take good care of their personal belongings, and not leave them unattended. Neither the Conference organizers nor their staff or the hotel staff will be responsible for any loss or damage of any personal property of the participants.

CATERING BREAKS

AM and PM Breaks will be located at the Main Building, Lobby Level and Second Floor and will be open at the following times:

AM BREAKS

- Sunday 29th July 1030 hours - 1100 hours
- Monday 30th July 1000 hours - 1030 hours
- Tuesday 31st July 1000 hours - 1030 hours
- Wednesday 1st August 1030 hours - 1100 hours
- Thursday 2nd August 1030 hours - 1100 hours

LUNCHESES

- Sunday 29th July 1300 hours - 1400 hours
- Monday 30th July 1230 hours - 1330 hours
- Tuesday 31st July Lunch box will only be provided to delegates attending the conference tours
- Wednesday 1st August 1300 hours - 1400 hours
- Thursday 2nd August 1300 hours - 1400 hours

PM BREAKS

- Sunday 29th July 1 1600 hours - 1630 hours
- Monday 30th July 1530 hours - 1600 hours
- Wednesday 1st August 1600 hours - 1630 hours
- Thursday 2nd August 1520 hours - 1550 hours

GENERAL INFORMATION

EXHIBITION

Exhibits area will be located at the Main Building, Lobby Level of The Westin Bayshore and will be open at the following times:

- Sunday 29th July 1030 hours - 2100 hours
- Monday 30th July 1000 hours - 1600 hours
- Tuesday 31st July 1000 hours - 1030 hours
- Wednesday 1st August 1030 hours - 1630 hours
- Thursday 2nd August 1030 hours - 1600 hours

CONFERENCE SESSIONS

Sessions will take place at The Main Building, Lobby Level and Second Floor and the Tower, Main Level and Mezzanine Level. Please refer to page 22 showing the venue floor plans.

GENERAL ASSISTANCE



Please visit the Registration Desk or ask one of the volunteers for help should you have any queries.

WI-FI

Delegates can access the wireless internet service throughout The Westin Bayshore. The complimentary Wi-Fi network is **Westin Conference** and the password is **icae2018**.

SOCIAL MEDIA

Follow us on Facebook and Twitter:

-  30th International Conference of Agricultural Economists
-  @ICAE_2018

Post or Tweet about ICAE 2018 using the following hashtags:

- #ICAE2018
- #agriculturaleconomists

GENERAL INFORMATION

SOCIAL PROGRAMME

Sunday, July 29th

Welcome Reception at the Westin Bayshore - Main Building, Lobby Level - Bayshore Grand Foyer at 1930 hours.

Monday, July 30th

Movie Screening - "Food Evolution" at the Westin Bayshore - Main Building, Lobby Level - Bayshore, Grand Ballroom at 2030 hours.

Tuesday, July 31st

Offsite Dinner at the Vancouver Aquarium at 1930 hours.

Thursday, August 2nd

Conference Dinner at the Westin Bayshore - Main Building, Lobby Level - Bayshore Grand Ballroom at 1930 hours.

Useful Information

BANKING HOURS

Regular bank hours are Monday to Friday from 0900 to 1700 hours. Many banks are closed on Saturday and Sunday, though some have limited services on a Saturday morning.

ATM

There are two ATMs machines close to The Westin Bayshore. Each within 10 min walking distance.

BMO ATM: 1720 Robson St, Vancouver, BC V6G 1E2

Vancity ATM: 1610 Robson St, Vancouver, BC V6G 1C7

BUSINESS CENTRE

The Westin Bayshore Hotel offers a fully-equipped business center. There is self-service facility featuring both PCs and Mac computers, a copier, printer, fax, and scanner, plus essential accessories such as a paper cutter and hole punchers.

CREDIT CARDS

Most credit cards are accepted in Canada. However, it is convenient to have cash on hand if you are buying small items from smaller shops.

GENERAL INFORMATION

CURRENCY

We recommend all visitors to use Canadian currency (Canadian Dollar - CAD) when travelling within Canada. Visitors can exchange currency at Canadian chartered banks, trust companies, credit unions, or at offices of foreign exchange brokers, or take it out using ATM machines. Some hotels, merchants, restaurants and suppliers accept USD or other foreign currency at a pre-determined rate, which may differ from the daily rate posted by financial institutions.

TAXATION

Most purchases in British Columbia are subject to a 7% Provincial Sales Tax (PST) as well as a federal 5% Goods and Services Tax (GST), with a few exceptions including liquor (10% PST) and accommodation (8% PST plus up to 3% hotel tax). Some goods such as food and restaurant meals, books and magazines, and children's clothing are GST and/or PST exempt. For more information, visit the Province of British Columbia's website: <https://www2.gov.bc.ca/gov/content/taxes/sales-taxes/pst>

LANGUAGE

The official language of the conference will be ENGLISH - there will be no simultaneous translation in sessions.

MOBILE PHONES

Out of courtesy to speakers and other delegates, mobile phones and pagers must be set to silent mode before entering sessions.

PARKING

The Westin Bayshore Hotel has parking available, subject to availability. For room guests: Self and valet parking \$40-45/day (including taxes). Public parking is available close to the hotel:

West Park

Address: 1620 Bayshore Dr, Vancouver, BC V6G 3L1

Distance from the hotel: 230 meters / 2 min

For more information: https://westpark.com/index.php?page_id=1

SHOPPING

Whether you are looking for a small souvenir from your visit to Vancouver or a brand new summer wardrobe, shopping ranks high on the list of vacation activities for many visitors. As a cosmopolitan metropolis, shopping here runs from international designers and popular brands in shop-'til-you-drop malls, through to local designers and one-of-a-kind craft studios in unique neighbourhoods.

GENERAL INFORMATION

SMOKING

British Columbia banned smoking in all public spaces and workplaces including within a 6-metre radius of doors, open windows and air intakes.

TRANSPORT

Vancouver is renowned as one of the world's most walkable cities, though taxis are also readily available everywhere and a hotel shuttle runs to downtown most days. A well-maintained public transportation system is easy to access and makes getting around town simple. TransLink is the Vancouver public transit system, which includes buses and trains.

The standard bus fare for up to 90 minutes is \$2.85. Please have exact change when purchasing a bus ticket on the bus.

SkyTrain fare starts from \$2.85 for Zone 1 but increases if one wishes to travel outside of the core city. You can purchase tickets for SkyTrain with credit or debit cards or with cash using the machines at the entrance of any SkyTrain station.

For more information, please visit:

- www.translink.ca
- www.tourismvancouver.com/plan-your-trip/getting-around/getting-to-the-airport/
- www.yvr.ca/en/getting-to-from-yvr.aspx

TIPPING

Gratuities are seldom included in Canadian restaurants. It is customary to tip approximately 15-20% on the total bill before tax, less for poor service, more for truly exceptional service. Many restaurants may charge an automatic 15-18% gratuity for large groups (usually from 6 people and above).

TIME ZONE

Vancouver is in the Pacific Time Zone, which is 7 hours behind GMT (UTC/GMT -7 hours). You can see Vancouver's time in relation to most cities around the globe by visiting www.thetimenow.com, which is also home to a Canadian calendar with important dates.

USEFUL TELEPHONE NUMBERS

Emergency Numbers

Ambulance, Fire, Police

Phone: 9-1-1

HealthLink BC

Phone: 8-1-1

Deaf Hearing-Impaired (TTY): 711

Taxi Numbers

Yellow Cab: (604) 681-1111

North Shore Taxi: (604) 922-2222

Black Top & Checker Cabs: (604) 681-3201



THE INTERNATIONAL FOOD POLICY RESEARCH INSTITUTE (IFPRI), established in 1975, provides research-based policy solutions to sustainably reduce poverty and end hunger and malnutrition. IFPRI's strategic research aims to foster a climate-resilient and sustainable food supply; promote healthy diets and nutrition for all; build inclusive and efficient markets, trade systems, and food industries; transform agricultural and rural economies; and strengthen institutions and governance. Gender is integrated in all the Institute's work. Partnerships, communications, capacity strengthening, and data and knowledge management are essential components to translate IFPRI's research from action to impact. The Institute's regional and country programs play a critical role in responding to demand for food policy research and in delivering holistic support for country-led development. IFPRI collaborates with partners around the world.

www.ifpri.org

FLOOR PLAN

Main Building, Lobby Level

SESSIONS WILL TAKE PLACE AT THE MAIN BUILDING, LOBBY LEVEL AND SECOND FLOOR AND THE TOWER, MAIN LEVEL AND MEZZANINE LEVEL.

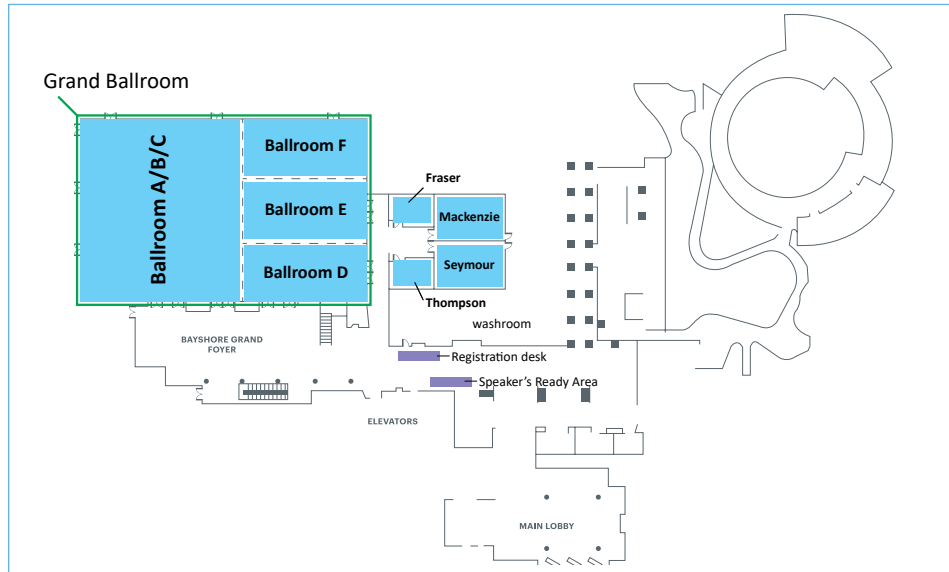

At the Main Building, Lobby Level, washrooms are located next to coat check area.

Main Building, Second Floor



At the Main Building, Second Floor, washrooms are located next to the Arbutus room.

FLOOR PLAN

Tower, Main Level

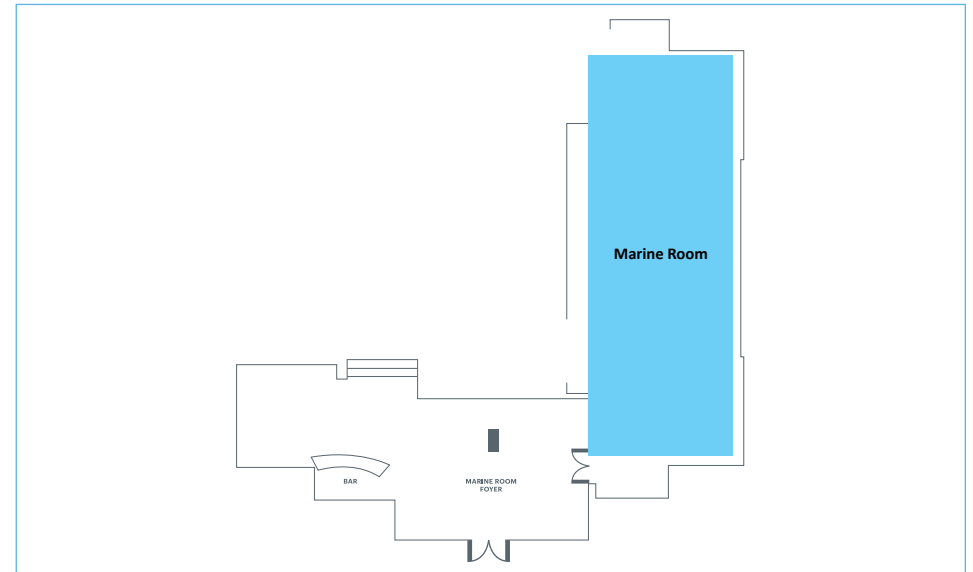

At the Tower, Main Level, washrooms are located next to the spa.

Tower, Mezzanine Level

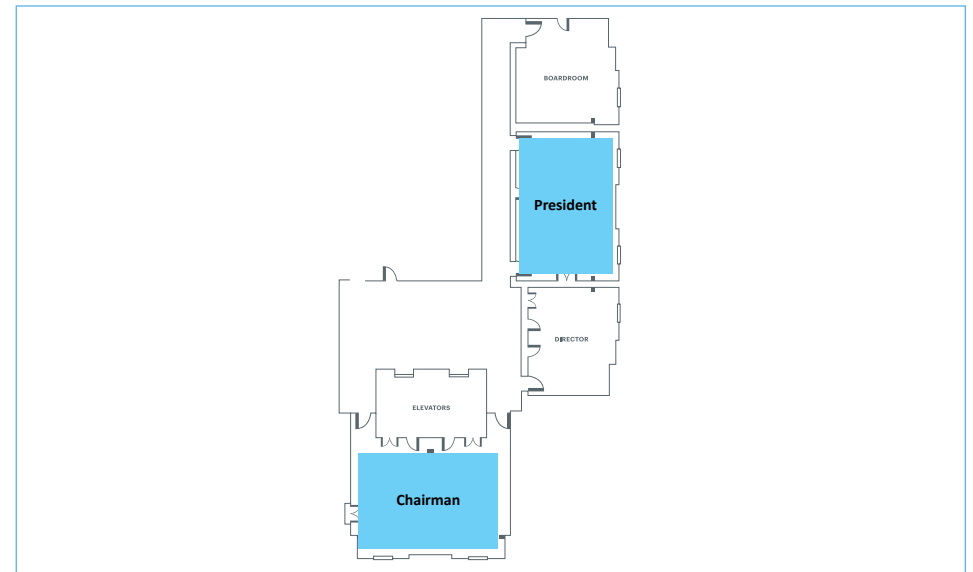

At the Tower, Mezzanine Level, washrooms are located next to the elevators.

SPEAKERS INFORMATION

CONTRIBUTED PAPER INSTRUCTIONS

The Contributed Paper sessions will normally consist of 12 Oral Paper sessions, 6 Organized Sessions and 4 Visual Paper sessions operating in parallel in the same time slot (sessions 4 and 8 will deviate from this pattern).

ORAL SESSIONS

Each presentation will last for 20 minutes. The more time the presenter takes, the less time will be available for the Question and Answer session. Please aim to talk for no longer than 15 minutes to leave enough time. The chairperson of each session will be the presenter of the last paper in that session, so s/he will keep you to your time very strictly!

A projector and computer (Windows, MS PowerPoint & Adobe Acrobat Reader) will be available in every session room for presentations. Speakers must arrive in their session room at least 15 minutes BEFORE the start of their session to report to the chair persons. An assistant from the local organization will also be available for technical assistance.

PLEASE NOTE THAT SPEAKERS MUST BRING A WINDOWS COMPATIBLE MEMORY STICK CONTAINING THEIR PRESENTATION FILE.

To avoid software compatibility problems, speakers are advised to EMBED ALL FONTS in their PowerPoint file AND bring a backup PDF-version of their presentation. If you have been designated as a chair for your session, you will have to be present at least 15 -20 minutes before the session is set to begin. You will also have to keep the presentations on time. In the event where a presenter is absent, it is important to keep their slot empty, this will allow people who are going between sessions to still have an accurate schedule.

SPEAKERS INFORMATION

INVITED PANEL / ORGANIZED SESSION

A projector and computer (Windows, MS PowerPoint & Adobe Acrobat Reader) will be available in every session room for presentations. Speakers must arrive in their session room at least 15 minutes BEFORE the start of their session to report to the chair persons. An assistant from the local organization will also be available for technical assistance.

PLEASE NOTE THAT SPEAKERS MUST BRING A WINDOWS COMPATIBLE MEMORY STICK CONTAINING THEIR PRESENTATION FILE.

To avoid software compatibility problems, speakers are advised to EMBED ALL FONTS in their PowerPoint file AND bring a backup PDF-version of their presentation.

UPLOADING YOUR PRESENTATION

The Speakers' Ready Area will be located across from the Registration desk on the Lobby Level.

All Presenters for Plenary, Invited Panels, Organized Symposia and Contributed Papers should visit this area at least two hours prior to the start of their session to upload their presentation to the network and to organize their materials. For sessions that commence at 0800 hours, speakers are required to upload their presentation the day before whenever possible. Technicians will be on hand in this area should speakers have any questions or require assistance.

SPEAKERS' READY AREA OPENING HOURS

Saturday 28 th July:	1200 hours - 1700 hours
Sunday 29 th July:	0700 hours - 1800 hours
Monday 30 th July:	0700 hours - 1700 hours
Tuesday 31 st July:	0700 hours - 1000 hours
Wednesday 1 st August:	0700 hours - 1500 hours
Thursday 2 nd August:	0700 hours - 1600 hours

VISUAL SESSIONS

These presentations will take place in four separate rooms, and each room will be equipped with an interactive monitor. In each 2 hour session up to 15 papers will be presented, i.e. you will have at least 8 minutes for your presentation. The monitors are the size of a large-screen TV but touchscreen so that a group of 15-20 people standing around it can all see properly if you design your slides properly. The presenters of these papers are asked to prepare a PowerPoint presentation of 3-5 slides (8 minutes for presentation and a question or two during the arranged sessions). Note however that the monitors, each loaded with all of the visual presentations, will be up in those rooms throughout the conference so presenters can also arrange their own presentations to smaller groups as and when they wish.

Speakers must arrive in their session room at least 15 minutes BEFORE the start of their session to report to the chair persons. An assistant from the local organization will also be available for technical assistance.

The presenter who appears last in the list of presenters under each session will chair all presentations under that title. The main functions of the chair are to keep presenters to time and to encourage questions and discussion.

All e-poster presenters have been sent an email with instructions on how to upload their presentation to the e-poster kiosk.

If you have not uploaded your file, please bring your presentation on USB stick to the Speakers' Ready Area.

T.W. SCHULTZ PRIZE FOR BEST CONTRIBUTED PAPER

Named after **Dr. Theodore W. Schultz**, an outstanding contributor to the IAAE and the agricultural economics profession. The award is given for the best oral contributed paper presented by a young professional at the triennial International Conference of Agricultural Economics.

NILS WESTERMARCK PRIZE FOR BEST POSTER

Named after Nils Westermarck, also an outstanding contributor to the IAAE and the agricultural economics profession. The prize is awarded for the best visual contributed paper presented by a young professional at the triennial International Conference of Agricultural Economics.

UMA LELE PRIZE FOR BEST CONTRIBUTED PAPER ON GENDER

This prize is funded by Uma Lele, a distinguished contributor to IAAE. Contributed papers submitted for the 2018 International Conference of Agricultural Economists that cover the following topics are eligible to compete: (i) promoting a better understanding of the contribution of women to agriculture and rural development as well as the impact of factors such as education, health, infrastructure, information and legal frameworks on changing gender roles in rural areas; (ii) demonstrating how rural women are affected by current or expected technological, economic, social and legal changes; and (iii) evaluating the policy, institutional, and other development interventions that aim to improve the welfare of rural women.

BEST ARTICLE IN AGRICULTURAL ECONOMICS

Eicher Award for the best PhD in Agricultural Economics with a theme from African agriculture

Family, friends and colleagues of the late Carl K. Eicher established a fund under the IAAE to support awards for the best PhD/MS dissertations on Sub-Saharan Africa and to honour the many contributions of Carl to African agricultural research and education. He was also an active member of the IAAE.

KEYNOTE SPEAKERS



ABDULAI, AWUDU (University of Kiel)

Prior to joining the faculty at the University of Kiel, Professor Abdulai (Ghanaian citizen) taught at the Swiss Federal Institute of Technology, Zurich (ETH) and also held visiting positions at the Departments of Economics at Yale University and Iowa State University, as well as the International Food Policy Research Institute, Washington, DC. His fields of interests span over Development Economics, Consumer Economics and Environmental and Resource Economics. He was Cargill Visiting Professor at the Center on Food Security and the Environment at the Institute for International Studies, Stanford University (2010 - 2011). He received the Outstanding Doctoral Dissertation Award in 1994 from Swiss Federal Institute of Technology, Zurich. Awudu is currently the Co-Editor-in-Chief, Agricultural Economics (Journal of the International Association of Agricultural Economists).



ACOSTA, ALEJANDRO (FAO)

Alejandro Acosta is an Agricultural Economist and Policy Officer at FAO. He has a special focus of interest in quantitative policy analysis, a strong track record of leadership and delivery in the food security and sustainable development policy spheres. Alejandro has more than fifteen years of working experience conducting quantitative policy analysis and supporting the formulation of sector strategies and investment programs in various developing regions, including specific field positions in Southern Africa, South America and Europe. Alejandro is currently managing the Livestock Policy Lab (LPL) at FAO, which aim is to identify windows of opportunity for policy reforms to enhance the contribution of the livestock sector to sustainable development. He has a keen interest in Food Policy, Industrial Organization, and Price Transmission. Alejandro holds a PhD in Agricultural Economics from the University of Göttingen.



ADAMOWICZ, VIC (University of Alberta)

Vic Adamowicz is the Vice Dean in the Faculty of Agricultural, Life and Environmental Sciences, and a Distinguished University Professor in the Department of Resource Economics and Environmental Sociology, University of Alberta. He obtained his BSc and MSc from the University of Alberta (1981, 1983) and his PhD from the University of Minnesota in 1988. His research has focused on the economic valuation of environmental amenities and ecosystem services and the incorporation of environmental values

KEYNOTE SPEAKERS

into economic analysis. His research also involves the analysis of choice behavior with applications to food demand, recreation, and environmental quality. He is a Fellow of the Royal Society of Canada, Academy II - Social Sciences (awarded in 2007). He became a Fellow of the Canadian Agricultural Economics Society in 2011. He was awarded the Canadian Institute of Forestry's Canadian Forestry Scientific Achievement Award in October, 2004.



AINEMBABAZI, HERBERT (AGRA)

John Herbert Ainembabazi (PhD) is an Agricultural Economist, working as a Program Officer for Alliance for a Green Revolution in Africa (AGRA). Herbert is responsible for research, agriculture sector policy analysis and identifying 'problem' policies limiting private sector investments in agricultural transformation in 11 African countries. In particular, he co-leads a program model that identifies policies that are outdated and irrelevant to the current situation, missing or ambiguous, economically flawed, excessively implemented or poorly implemented. The model's approach is to work with and within government to reform 'problem' policies in collaboration with other development partners by facilitating and fast-tracking the implementation of administrative and legislative processes through approval of the legal framework. The model has been attested with considerable successes in Nigeria, Ghana, Ethiopia, Burkina Faso and Tanzania. The model is now being rolled out in six other African countries.



ALSTON, JULIAN (University of California, Davis)

Julian M. Alston is a distinguished professor in the Department of Agricultural and Resource Economics of the University of California at Davis, where he teaches graduate and undergraduate classes in microeconomic theory and the analysis of agricultural markets and policies. He earned a Bachelor's degree in Agricultural Science from the University of Melbourne, a Master's degree in Agricultural Economics from La Trobe University, and a PhD in Economics from North Carolina State University, all with the support of the Victorian Department of Agriculture. Prior to beginning in his current position in 1988, Dr Alston had served for several years as the Chief Economist in the Department of Agriculture and Rural Affairs in Victoria, Australia, where he had been employed in various capacities since 1975. Alston's experience in public policy analysis

KEYNOTE SPEAKERS

and advice, and administration of a large scientific organization shaped his research interests in the economic analysis of agricultural and food policy.



ANDERSON, KYM (University of Adelaide)

Kym Anderson is the George Gollin Professor of Economics, foundation Executive Director of the Wine Economics Research Centre, and formerly foundation Executive Director of the Centre for International Economic Studies at the University of Adelaide in Australia, where he has been affiliated since 1984. Previously he was a Research Fellow at the Australian National University's Research School of Pacific and Asian Studies (1977-83), following doctoral studies at the University of Chicago and Stanford University (1974-77); and in 2012 he re-joined ANU part-time as a Professor of Economics in the Arndt-Corden Dept. of Economics in its Crawford School of Public Policy. He was on extended leave at the Economic Research division of the GATT (now WTO) Secretariat in Geneva during 1990-92 and at the World Bank's Development Research Group in Washington DC as Lead Economist (Trade Policy) during 2004-07. He has published more than 300 articles and 30 books, including *The Political Economy of Agricultural Protection* (with Yujiro Hayami), *Disarray in World Food Markets* (with Rod Tyers), *Agricultural Trade Reform and the Doha Development Agenda* (with Will Martin), *The World's Wine Markets: Globalization at Work* and, during 2008-10 following a large World Bank research project that he led, a set of 4 regional and 3 global books on Distortions to Agricultural Incentives



ARIGA, JOSHUA (IFDC)

Joshua Ariga is Senior Economist, Markets, Economics and Policy Unit, the International Fertilizer Development Center (IFDC). Ariga has provided leadership for research on agricultural policy, institutional reforms, rural development, subsidies, and market assessments in Asia and African countries. He has worked as a consultant for the World Bank, IFPRI, FAO, donor and other organizations, and as Research Fellow with Michigan State University & Tegemeo Institute of Agricultural Policy and Development (Kenya) on agricultural productivity and policy advocacy. He has extensive experience advising policy makers, coordinating household surveys, conducting market assessments, cost-benefit analysis of

KEYNOTE SPEAKERS

input technologies and investments, training and capacity building, developing partnerships, and organizing and managing workshops, with the goal of alleviating poverty. He has authored and co-authored a number of publications and chapters in books covering a range of agricultural issues. In recognition of outstanding impact on agricultural and related policy, he received the Bruce Gardner Memorial Prize for applied policy analysis in 2017. Ariga is an agricultural economist with a doctorate (Michigan State University, USA), a master's (University of Arizona, USA), and a bachelor's degree (Egerton University, Kenya), and over 17 years of experience on agricultural markets and policy research.



BADIANE, OUSMANE (IFPRI)

Dr Ousmane Badiane, recipient of the Africa Food Prize in 2015, is the Director for Africa at the International Food Policy Research Institute (IFPRI). In this role, he oversees the institute's two regional offices for West and Central Africa in Dakar and Eastern and Southern Africa in Addis Ababa. He coordinates IFPRI's work program in the areas of food policy research, capacity strengthening, and policy communications in Africa. He is also in charge of IFPRI's partnerships with African institutions dealing with the above areas. As an Advisor to the NEPAD Secretariat from 2004 to 2007, he was instrumental in developing and guiding the implementation of the Comprehensive Africa Agriculture Development Programme (CAADP). Before his current tenure at IFPRI, Dr Badiane, a national of Senegal, was Lead Specialist for Food and Agricultural Policy for the Africa Department at the World Bank from January 1998 to August 2008. He previously worked at IFPRI as Senior Research Fellow from 1989 to 1997, when he led the institute's work on market reforms and development. While at IFPRI, he taught Economics of Development in Africa, as adjunct professor at Johns Hopkins University's School of Advanced International Studies from 1993 to 2003. Dr Badiane received a Master's Degree and PhD in agricultural economics from the University of Kiel in Germany. He is also recipient of a Doctoral Degree Honoris Causa from the University of KwaZulu-Natal in South Africa.

KEYNOTE SPEAKERS



BANSE, MARTIN (Thünen Institute of Market Analysis)

Martin is the Director of the Thünen Institute of Market Analysis in Braunschweig, Germany and has over 15 years' experience in quantitative analyses of agricultural policy and international trade. He has done much work in agricultural sector analysis and quantitative modelling, and has extensive experience in working with partial and general equilibrium models. Martin's educational history includes Agricultural economics (Habilitation: Development and application of equilibrium models to analyse the competitiveness of the agricultural and food economy and the impact of increasing demand for bioenergy on agricultural markets) at Georg-August University of Göttingen, Germany, in 2009. He holds a Ph.D. (Thesis: Transition of Hungarian Agri-food Industries) and Masters (Thesis: Economy-wide impact of agricultural policies in Germany) from Georg-August University of Göttingen, Germany. Prior to his current position, Martin was a senior researcher at Johann Heinrich von Thünen-Institute (2006 - 2009) and an Assistant Professor (2001 - 2006) focusing on modelling with partial and general equilibrium models and agricultural policy advice at Georg-August University of Göttingen, Germany.



BIRNER, REGINA (University of Hohenheim)

Regina Birner is Chair of Social and Institutional Change in Agricultural Development at the University of Hohenheim, Germany. Her research focuses on the political economy of agricultural policy processes and on the role of governance and institutions in agricultural development, with a focus on smallholder farming. Gender is a cross-cutting concern in her research. Regina Birner has extensive empirical research experience in Africa and in South and South-East Asia, and she has published widely in these fields. She is a member of the Advisory Council on Agricultural Policy of the German Federal Ministry of Food and Agriculture (BMEL) and a member of the Advisory Council on Bioeconomy of the German Federal Government. She has been consulting with international organizations, including the World Bank, the Food and Agriculture Organization (FAO) and the International Fund for Agricultural Development (IFAD). Regina Birner holds a postdoctoral degree ("Habilitation") in Agricultural Economics and a PhD in Socio-Economics of Agricultural Development, both from the University of Göttingen. She received her M.Sc. degree in Agricultural Sciences from the Technische Universität München-Weihenstephan, Germany.

KEYNOTE SPEAKERS



BIROL, EKIN (HarvestPlus)

Ekin joined HarvestPlus in 2010 as the Head of Impact Research Unit. She first joined IFPRI in 2007 as a Research Fellow with the Markets, Trade and Institutions Division. From 2004 to 2007 she was a Postdoctoral Research Fellow at the University of Cambridge. While at Cambridge, she conducted research on the development and application of economic methods to inform sustainable policies for environmental conservation and natural resources management. From 2000 to 2004 Ekin was a Research Fellow of the Centre for Social and Economic Research on the Global Environment (CSERGE), University College London. She also worked as a consultant for IFPRI's Environment and Production Technology Division from 2004 to 2005, and for Bioversity International from 2001 to 2004. Ekin taught graduate and undergraduate level courses at the universities of Cambridge, London and Reading. She obtained a PhD in economics with a concentration in agricultural and resource economics; an MPhil in economics with a concentration in development economics and econometrics, and an MSc in environmental and resource economics, all from University College London. She is a citizen of Turkey and UK.



BOHMAN, MARY (ERS)

At the end of 2011, Dr Bohman took over as Administrator of the USDA Economic Research Service (ERS), an agency that carries out economic research that helps public and private decision-makers stay informed of economic and policy issues involving food, farm production, natural resources, rural development and foreign demand and competition. Bohman earned her B.S. in Foreign Service from the School of Foreign Service at Georgetown University in 1980, and her Ph.D. from the Department of Agricultural Economics at the University of California at Davis in 1991, with a dissertation entitled, "The impact of the International Coffee Agreement on policy in exporting countries." She had already obtained academic employment, working as Assistant Professor of Agricultural Economics at the University of British Columbia, in Vancouver from 1990 to 1997. Her specialty was international trade and development. She served as Director of ERS's Resource and Rural Economics Division from circa 2000 to July 2011.

KEYNOTE SPEAKERS



BOXALL, PETER (CAES and University of Alberta)

Peter is President of the Canadian Agricultural Economics Society (CAES) and a Professor of Environmental and Resource Economics in the Department of Rural Economy, Faculty of Agricultural, Life and Environmental Sciences at the University of Alberta. He obtained his BSc and MSc degrees in Biology from Queen's and Calgary respectively, after which he earned MSc and PhD degrees from the University of Alberta. Peter's research focuses on the economic valuation of environmental goods and services and utilises both revealed and stated preference methods. Peter and his students try to incorporate these values into the development and analysis of environmental and conservation policy. He is the leader of the Linking Environment and Agriculture Research Network (LEARN) as a participant in the Land Reclamation International Graduate School (LRIGS) program. Recent research in his research group has involved determination of the costs and benefits of restoring wetlands on agricultural landscapes in the prairie pothole region. These efforts are leading to the design of market-based instruments, such as reverse auctions and offset trading systems, to encourage increased provision of ecological goods and services from private land managers. Much of this research involves the use of experimental economic techniques to design market-based approaches that target incentives to address specific environmental outcomes.



BROOKS, KAREN (IFPRI)

Karen Brooks joined IFPRI in 2012 as Director, CGIAR Research Program on Policies, Institutions, and Markets. Prior to that she worked for the World Bank for more than 20 years, primarily on agricultural development in Africa, Europe, and Central Asia. For the last 10 years of her tenure at the World Bank, she managed analytical and operational programs in the Africa Region. Brooks has published on issues related to price and land policy in countries transitioning from planned to market economies, and on challenges of youth employment in Africa South of the Sahara. Prior to joining the World Bank, she was Associate Professor in the Department of Applied Economics at the University of Minnesota. Brooks received both her PhD and Master's degrees in Economics from the University of Chicago, where she was a National Science Foundation Graduate Fellow.

KEYNOTE SPEAKERS



CARDWELL, RYAN (University of Manitoba)

Ryan Cardwell is an associate professor in the Department of Agribusiness & Agricultural Economics at the University of Manitoba. Ryan is president of the Canadian Council of the International Association of Agricultural Economists and is a member of the editorial board at Canadian Journal of Agricultural Economics. Ryan's research focuses on international trade regulation and foreign aid, with a focus on food assistance. Recent research topics include the distributional effects of Canadian agricultural policies, the merging of aid agencies with departments of international trade, and the untying of food assistance from domestic procurement. His work on the distributional effects of agricultural policies was recently awarded the John Vanderkamp Prize, given by the Canadian Economics Association for the best article in the journal *Canadian Public Policy*.



CARLETTO, GERO (World Bank)

Calogero (Gero) Carletto is a Lead Economist and Manager of the Living Standards Measurement Study (LSMS) in the Development Data Group at the World Bank. As part of the LSMS activities, he is also coordinating a large methodological research program on the improvement of productivity measurement in agriculture, as well as a new research program on poverty and food security measurement. His research interests are in the areas of poverty, food security, agriculture and rural development, as well as data collection methods and measurement issues. Most recent research includes publications in the Journal of Development Economics, World Development and Labour Economics. He has previously worked for various UN agencies and the International Food Policy Research Institute (IFPRI). He holds a Ph.D. in Agricultural and Resource Economics from the University of California at Berkeley.



CHRISTIAENSEN, LUC (World Bank)

Luc Christiaensen is a lead agriculture economist in the World Bank's Jobs Group and an honorary research fellow at the Maastricht School of Management. He takes a keen interest in issues related to poverty and food security, the rural-urban transformation, and project impact evaluation. Luc has written extensively on poverty, secondary towns, and structural transformation in Africa and East Asia. Currently, he is also leading the "Agriculture in Africa: Telling Facts from Myths" project. He was a core member of the team that

KEYNOTE SPEAKERS

produced the World Development Report 2008: Agriculture for Development and a Senior Research Fellow at the United Nations University-WIDER in Helsinki during 2009-2010. He holds a PhD in agricultural economics from Cornell University.



CONIJN, SJAAK (Wageningen University and Research)

Sjaak is a senior scientist at the business unit Agrosystems Research, part of Wageningen University and Research. He and his colleagues conduct contract research on sustainable agronomic systems and land use. Our approach is based on agroecology, where processes from different levels are integrated to better understand the behavior of a system. He has an extensive experience in modelling various ecosystems from the field level up to the global food system, concentrating on the central theme of producing enough with a lower environmental footprint. An important part of his research focuses on understanding trade-offs and synergies as a function of the system's boundaries. His latest work is about calculating the multiple effects of combining measures in a food system in relation to planetary boundaries.



DONALDSON, DAVE (MIT)

Dave Donaldson teaches and carries out research on topics at the intersection of International/Intranational Trade, Development Economics, Economic History and Environmental Economics. He has studied, among other topics: the welfare and other effects of market integration, the impact of improvements in transportation infrastructure, how trade might mediate the effects of climate change, and how trade affects food security and famine. This work has been awarded the 2017 John Bates Clark Medal, given by the American Economic Association to the US-based economist under the age of forty who is judged to have made the most significant contribution to economic thought and knowledge, as well as an Alfred P. Sloan Research Fellowship and several grants from the National Science Foundation. He currently serves as a co-editor at the American Economic Journal: Applied Economics, as an editorial board member at the Journal of Economic Literature, the Journal of International Economics, the Review of Economic Studies, and the Quarterly Journal of Economics, and as a program director (for Trade) at the International Growth Centre. A native of Toronto, Canada, Donaldson obtained an undergraduate degree in Physics from Oxford University and a PhD in Economics from the London School of Economics.

KEYNOTE SPEAKERS



DUMORTIER, JEROME (Indiana University)

Jerome Dumortier joined Indiana in August 2011 after receiving his Ph.D. in Economics from Iowa State University. His research focuses on energy and agricultural economics, especially bioenergy and land-use change. In the past, the interaction between the agricultural, energy, and carbon policies have been subject of his work. Among others, he has worked as a consultant for the European Commission's Joint Research Center (JRC) to evaluate the land-use change implications of EU biofuel policy. His current research agenda emphasises on the economics of switch grass for biomass co-firing and biofuel production; and the market penetration of electric vehicles. He has published peer-reviewed academic articles that use simulation models to determine the effects of biofuel and carbon policies on agricultural productions. Jerome's most recent research focuses on transportation related issues such as plug-in vehicles and fuel taxation.



FORBES, CHRIS (AAFC)

On May 29, 2017, Chris Forbes was appointed Deputy Minister of Agriculture and Agri-Food Canada (AAFC). Prior to returning to AAFC, Mr. Forbes served as Associate Deputy Minister of the Department of Finance from November 2016 to May 2017. He was Associate Deputy Minister of Agriculture and Agri-Food Canada from January 2015 to November 2016. From May 2013 to January 2015, Mr. Forbes was Assistant Deputy Minister, Strategic Policy Branch and Regional Directors General Offices at Environment Canada. From November 2010 to May 2013, he was Assistant Deputy Minister, Federal-Provincial Relations and Social Policy Branch at the Department of Finance. Mr. Forbes joined the federal government in 2000, and has held several senior positions in the areas of policy development, economic analysis and regulations and managed a range of regional programs. He has also worked for the Government of the Northwest Territories and the Toronto Dominion Bank. Mr. Forbes holds a Masters in Economics from McGill University.



GERBER, JAMES (University of Minnesota)

James is the co-director and lead scientist of the Global Landscapes Initiative at the University of Minnesota's Institute on the Environment. He and his research team develop solutions for improving global food security while improving environmental outcomes. The team has published broadly in the area of quantifying the impact of



KEYNOTE SPEAKERS

agriculture on the earth's ecosystems. Dr Gerber's research focus is the interrelation of climate variability, crop yields, and systemic trends in food security. He holds a doctorate in physics from the University of California, Santa Cruz.



GIL, JOSÉ M. (CREDA-UPC-IRTA and EUROCHOICES)

José is serving on the advisory board of EUROCHOICES and is a Professor in Agricultural and Food Economics and the Director of the Center for Agro-food Economy and Development (CREDA), a research and development system promoted by Universitat Politècnica de Catalunya (Catalonia Polytechnic University (UPC)) and the Institut de Recerca i Tecnologia Agroalimentàries (Institute for Food and Agricultural Research and Technology (IRTA)). He completed his Bachelor in Business Economics (1985), Degree Thesis (1986), and PhD in Economics (1991) all at the University of Zaragoza, whilst graduating with Masters of Science in Agro-Food Marketing degree (1990) from Centre International des Hautes Etudes Agronomiques Méditerranéennes (CIHEAM) in Zaragoza. His scientific contributions include 12 books, 17 book chapters, and over 170 journal articles.



GLAUBER, JOE (IFPRI)

Joe Glauber is a Senior Research Fellow at the International Food Policy Research Institute in Washington, DC where his areas of interest are price volatility, global grain reserves, crop insurance and trade. Prior to joining IFPRI, Glauber spent over 30 years at the U.S. Department of Agriculture including as Chief Economist from 2008 to 2014. As Chief Economist, he was responsible for the Department's agricultural forecasts and projections, oversaw climate, energy and regulatory issues, and served as Chairman of the Board of Directors of the Federal Crop Insurance Corporation. From 2007-2009, Glauber was the Special Doha Agricultural Envoy at the office of the U.S. Trade Representative where he served as chief agricultural negotiator in the Doha talks. He served as economic adviser at the so-called Blair House agreements leading to the completion of the Uruguay Round negotiations. He is the author of numerous studies on crop insurance, disaster policy and U.S. farm policy. Dr. Glauber received his Ph.D. in agricultural economics from the University of Wisconsin in 1984 and holds an AB in anthropology from the University of Chicago. In 2012, he was elected Fellow of the Agricultural and Applied Economics Association.

KEYNOTE SPEAKERS



GREBITUS, CAROLA (Arizona State University)

Carola is an assistant professor of food industry management at the W. P. Carey School of Business at Arizona State University. Her research is focused on modelling consumers' food choices in general, and consumers' decision strategies in particular. She has worked extensively on determinants of consumer behaviour, purchase decision making, and food quality from consumers' perspective. Her current research includes consumer preferences for local food, urban agriculture, and sustainable (food) products; willingness to pay for new technologies; and the influence of food labelling on purchase decisions. Furthermore, she investigates the role of social networks on healthy food choices and adoption of genomics. Also, she has conducted research using retail surveys regarding consumers' use of quality certification and country-of-origin information. In her research Professor Grebitus applies a variety of methods ranging from auctions and choice experiments to eye tracking and taste tests. At ASU, she teaches courses in Food Product Innovation and Development and Food Promotion and Advertising, with heavy emphasis on food retail.



HAYASHIDA, KÔHEI (University of Tokyo)

He started his academic career in agriculture as an undergraduate at Kyoto University, Kyoto, Japan. He is currently a graduate student at the Graduate School of Agriculture and Life Sciences at the University of Tokyo.



HAZELL, PETER (Independent Consultant)

Peter Hazell has devoted most of his career to research and advisory work on policy issues related to agricultural development, with his present focus on bioenergy issues related to agriculture, the links between agriculture and the environment, and the role of agriculture in the development of Africa and South Asia. As a trained agriculturalist he has had a long and distinctive career in research and policy analysis involving various positions at the World Bank and the International Food Policy Research Institute (IFPRI) between 1972 and 2005. Having worked throughout Africa, Asia, the Middle East and Central America during his career in research and policy analysis, he is now based in the UK as a Visiting Professor at Imperial College London and a Professorial Research Associate at the School of Oriental and African Studies, University of London.

KEYNOTE SPEAKERS

Peter's extensive and widely cited publications include works on mathematical programming; risk management; insurance; the impact of technological change on growth and poverty; the rural nonfarm economy; sustainable development strategies for marginal lands; the role of agriculture in economic development: and the future of small farms.



HEADEY, DEREK (IFPRI)

Derek Headey is a Senior Research Fellow in the Poverty, Health and Nutrition Division at the International Food Policy Research Institute (IFPRI), where he has worked since 2008. A development economist, his research currently focuses on agricultural development and nutrition, though he has also worked on food security and poverty reduction issues. He has published in a variety of journals in economics, development, agriculture and public health, including World Bank Economic Review, Proceedings of the National Academy of Sciences (PNAS), World Development, World Bank Research Observer, Population and Development Review, PLOS One, American Journal of Tropical Medicine and Hygiene, and many others. He also co-authored a widely cited book on the global food crisis with Shenggen Fan, and a number of journal articles on the cause and consequences of higher food prices. He received his PhD in Economics from the University of Queensland in 2008.



HERRINGTON, CAITLIN (HarvestPlus)

Caitlin Herrington is a Research Analyst II at the International Food Policy Research Institute, working in the HarvestPlus Program. Her work is focused on conducting economic research predominately in the areas of impact assessments, adoption studies, and consumer acceptance to target and maximize the impact of biofortified crop delivery throughout Africa and Asia. She holds an M.S. degree in Agricultural Economics from Kansas State University and two B.S. degrees in Agricultural Business Management and Plant Biology from North Carolina State University. Prior to joining HarvestPlus in October 2014, Caitlin worked at an international microfinance nonprofit based in Chicago, IL where she served as a research and evaluation associate.

KEYNOTE SPEAKERS



HOBBS, JILL (University of Saskatchewan)

Jill E. Hobbs is a Professor in the Department of Agricultural and Resource Economics at the University of Saskatchewan, Canada. She received her Ph.D. in Agricultural Economics from the University of Aberdeen in 1995. Her research focuses on food policy, consumer behaviour, and supply chain economics. Her work has examined a range of issues including consumer trust, food safety and quality, traceability in agri-food supply chains, and the regulation of health foods. She is a former president of the Canadian Agricultural Economics Society. She served as co-editor of the Canadian Journal of Agricultural Economics from 2013-2016, and has served on the editorial advisory board of several academic journals. She was appointed to an honorary chair in the School of Business and Management at Aberystwyth University (2014-2019) and became a Fellow of the Canadian Agricultural Economics Society in 2017.



JAYNE, THOMAS (Michigan State University)

Thomas Jayne is University Foundation Professor of Agricultural, Food, and Resource Economics at Michigan State University and Co-Director of the Alliance for African Partnership, a university-wide initiative to promote long-term collaborations with African research and policy organizations. Jayne is a Fellow of the Agricultural and Applied Economics Association (AAEA) and Distinguished Fellow of the African Association of Agricultural Economists. His current research focuses on land policy and economic transformation. Thom has mentored dozens of young African professionals and supported the development of African agricultural policy research institutes. In 2017, he became the Flagship Co-Leader of the CGIAR Policies, Institutions and Markets research program on Economy-wide Factors Affecting Agricultural Growth and Rural Transformation. Over the past decade, he has received six research excellence awards, including the 2009 Outstanding Article Award in Agricultural Economics and the 2017 AAEA Bruce Gardner Memorial Prize for Applied Policy Analysis.



JOSEPHSON, ANNA (Purdue University)

Anna is currently an Assistant Professor in Economic Development. Anna's research examines issues of gender, labour, and households, focusing on the context of agriculture in economic development. Her current research extends her doctoral work on households facing risky conditions in Africa. Additionally, she studies entrepreneurship

KEYNOTE SPEAKERS

and small business disaster resilience, following Hurricane Katrina. These two strands of study are tied together through the focus on how stakeholders, whether they be rural households in the developing world or small businesses in North America, mitigate risk and cope with realized crises. Dr Josephson also studies instructional pedagogy, including active learning techniques and peer-to-peer evaluation. She researches these methods and their impacts on student learning, for best use in the classroom environment. She holds a Ph.D. (2017) in Agricultural Economics and Masters (2013) from Purdue University, whilst completing a Bachelors (2011) in Economics and Geology at Rensselaer Polytechnic Institute.

KISHORE, AVINASH (IFPRI)

Avinash Kishore joined IFPRI in September 2012 as a Post-Doctoral Fellow after completing his PhD in Public Policy from Harvard University. He obtained Masters in Public Affairs from Princeton University before joining the PhD program. Avinash studied at IRMA and worked for four years with International Water Management Institute (IWMI) before going to the US for higher studies. Avinash is interested in agriculture, environment, and development economics. At IFPRI, he will work on projects that seek to bridge the gap between laboratories and farms in Indian agriculture using action research in collaboration with agricultural universities, agribusiness firms and farmers.

KOUTCHADÉ, PHILIPPE (INRA SMART-LERECO)

Phillippe is currently enrolled for a Ph.D. at Inra's Smart-Lereco research unit in Rennes with a topic covering farmers' production choices modelling: accounting for unobserved heterogeneity and for agricultural production dynamics. The aim of the thesis is to investigate two issues for improving agricultural production choice micro-econometric models: to account for unobserved heterogeneity by using random parameter specifications on the one, and to account for crop rotation effects by considering dynamic models on the other hand. His supervisor is Alain Carpentier. Phillippe's research interests and topics include applied micro-econometrics and agricultural production micro-economics. Together with Carpentier and Féménia, Phillippe is working on: "Accounting for farms' and farmers' heterogeneity in agricultural production micro-econometric models: a random parameter approach" as well as "Corner solutions in empirical acreage choice models: an endogenous switching regime approach with regime fixed costs."

KEYNOTE SPEAKERS



KRAMER, BERBER (IFPRI)

Berber Kramer is an applied micro-economist in the Markets, Trade and Institutions Division of IFPRI. She joined IFPRI in 2013 and has a Ph.D. in Economics from the Tinbergen Institute in the Netherlands. Her research analyses programs and policies that can help smallholder farmers in developing countries cope with unexpected expenditures or income losses, due to, for instance, illnesses and injuries or to extreme weather events damaging their crops. Berber leads the cluster of research on agricultural risk management for the CGIAR Research Program on Policies, Institutions and Markets (PIM), co-leads the learning platform on agricultural index insurance for the CGIAR Research Program on Climate Change, Agriculture and Food Security (CCAFS), and is the lead Principal Investigator for the Picture-Based Insurance (PBI) initiative, which develops and evaluates crop insurance products that use smartphone camera data for claims settlement and risk management advice. In other projects, she uses high-frequency panel data and field experiments to study the impact and take-up of health insurance, the effects of liquidity constraints and time inconsistency on household savings and health-seeking behaviour, and interventions intended to make agricultural value chains more nutrition-, health-, and gender-sensitive.



KUMAR, VIPIN (University of Minnesota)

Vipin Kumar is a Regents Professor at the University of Minnesota, where he holds the William Norris Endowed Chair in the Department of Computer Science and Engineering. Kumar received the B.E. degree in Electronics & Communication Engineering from Indian Institute of Technology Roorkee, India, in 1977, the M.E. degree in Electronics Engineering from Philips International Institute, Eindhoven, Netherlands, in 1979, and the Ph.D. degree in Computer Science from University of Maryland, College Park, in 1982. Kumar's current research interests include data mining, high-performance computing, and their applications in Climate/Ecosystems and health care. He has authored over 300 research articles, and has coedited or co-authored 10 books including two text books "Introduction to Parallel Computing" and "Introduction to Data Mining", that are used world-wide and have been translated into many languages.

KEYNOTE SPEAKERS



MABAYA, EDWARD (Cornell University)

Dr. Ed Mabaya is an academic and practitioner with two decades of experience in agricultural development, agribusiness value chains and food security issues in Africa. He is a Senior Research Associate in the Charles H. Dyson School of Applied Economics and Management at Cornell University. He is involved in several research and outreach programs that seek to improve the lives of African farmers through promotion of private enterprises and public policy reform. He founded and currently leads The African Seed Access Index (www.TASAI.org) and the Seed of Development Program. He conducts applied research on food marketing and distribution, seed systems, enabling environments, and the role of efficient agricultural markets in Africa's economic development. In 2007 he was an Archbishop Desmond Tutu Leadership Fellow and in 2016 he was an Aspen Institute's New Voices Fellow. Ed is the current president of the African Association of Agricultural Economists (2016-2019).



MARTIN, WILL (IFPRI)

Will Martin, IAAE President, is a Senior Research Fellow at the International Food Policy Research Institute. He trained in economics and agricultural economics at the University of Queensland, the Australian National University and Iowa State University and worked at the Australian Bureau of Agricultural Economics; the Australian National University and the World Bank before joining IFPRI in 2015. His recent research has focused primarily on the impacts of changes in food and trade policies and food prices on poverty and food security in developing countries. He has also examined the impact of major trade policy reforms—including the Uruguay Round; the Doha Development Agenda; and China's accession to the WTO—on developing countries; implications of climate change for poor people; and the implications for the poor of improvements in agricultural productivity in developing countries.



MCCLUSKEY, JILL (Washington State University)

Jill J. McCluskey is Distinguished Professor of Sustainability and Associate Director of the School of Economic Sciences at Washington State University. She received her Ph.D. in Agricultural and Resource Economics in 1998 from the Univ. of California, Berkeley. Her research focuses on product quality and reputation, sustainable labeling, consumer preferences for new technology, and women in STEM. An award-winning researcher, she has published over 100 journal

KEYNOTE SPEAKERS

articles, many of which are highly cited. Her research has been funded by private foundations, NSF, and USDA. She has served as major professor to 36 Ph.D. graduates. She is past President and 2018 Fellow of the Agricultural and Applied Economics Association. She has served on editorial boards and as guest editor for several academic journals. She is member of the Board on Agricultural and Natural Resources of the National Academies of Sciences. Her research has been highlighted by various media outlets including the New York Times, National Public Radio, and Newsday.



MEENAKSHI, J.V. (Delhi School of Economics)

J.V. Meenakshi is on the faculty of the Delhi School of Economics, University of Delhi, India, where she teaches courses in econometrics and food and agricultural policy. Her recent research has focused on the economics of malnutrition, and on agriculture-nutrition linkages. Her other research areas include the microeconomics of cereal and water markets in rural India, food demand and poverty. She serves on various technical committees of the Government of India, including the National Statistical Commission and is currently a member of the Standing Panel on Impact Assessment of the CGIAR. She obtained her Master's and PhD degrees from Cornell University in Agricultural Economics.



MELLOR, JOHN (Independent Consultant)

John Mellor is currently Professor Emeritus, Cornell University and President of John Mellor Associates, Inc. a policy consulting firm. Prior to that he was founding Director General of the International Food Policy Research Institute, Chief Economist of the United States Agency for International Development (USAID/Washington,) and Vice-President of Abt Associates. At Cornell University he is now Professor Emeritus, and was Professor of Agricultural Economics, Economics, and Asian Studies, Director of the Comparative Economics Program and Associate Director and Acting Director of the Center for International Studies. He received degrees from Cornell University and Oxford University. He was the recipient of the Wihuri Prize (Finland) and the Presidential Award (The Reagan White House, USA) for efforts to alleviate hunger in the World and is an elected Fellow of the American Academy of Arts and Sciences, the American Association for the Advancement of Science, and the American Agricultural Economics Association. He is the recipient of numerous awards for the quality of his research, the author and co-

KEYNOTE SPEAKERS

author of ten books, and hundreds of journal articles and conference papers (largely on economic and agricultural development.)



MOGUES, TEWODAJ (IFPRI)

Tewodaj joined IFPRI in 2005, and is a Senior Research Fellow in IFPRI's Development Strategy and Governance Division. She leads the research cluster on Public Investments and Institutions under the CGIAR Research Program on Policies, Institutions, and Markets. Her research interests include public investments in rural areas, local public finance and decentralisation, political economy, public service delivery, and social capital. Much of her empirical research has been on Ethiopia, Ghana, Mozambique, Nigeria, and Uganda. Dr Mogues received her Bachelors in Economics from Kalamazoo College (1995), and her Ph.D. in Agricultural and Applied Economics from the University of Wisconsin-Madison (2005). She was born in Ethiopia and is a German citizen. Tewodaj has published numerous journal articles and book chapters, serves as co-editor of the 'European Journal of Development Research', and is editor of the book 'Public Expenditures for Agricultural and Rural Development in Africa'.



MUYANGA, MILU (Michigan State University)

Milu Muyanga is an assistant professor in the Department of Agricultural, Food and Resource Economics at Michigan State University. Muyanga's research focuses on agricultural land and water constraints, agricultural markets, and poverty and inequality issues. He was the first prize winner of the 2007 Global Development Network's medal on the best research on household exposure to risk theme. Prior to his doctoral studies, Milu Muyanga worked as a Research Fellow with Tegemeo Institute of Agricultural Policy and Development, Egerton University (Kenya) between 2004 and 2007. Before then he worked as an Economist in the Ministry of Planning and National Development in the Government of Kenya between 1997 and 2003.



NANKHUNI, FLORA (New Alliance Policy Acceleration Support (NAPAS))

Dr. Flora Nankhuni is associate professor in the Department of Agricultural, Food and Resource Economics at Michigan State University. Before joining Michigan State University in 2014, she worked in the Independent Evaluation Group of the World Bank (IEG), the International Finance Corporation (IFC), the Poverty

KEYNOTE SPEAKERS

Reduction and Economic Management (PREM) unit of the World Bank, and the Independent Evaluation Arrangement of the CGIAR hosted by the Food and Agriculture Organization of the United Nations (FAO). She was also a post-doctoral fellow at the University of Pennsylvania Population Studies Center and an Intern at the International Food Policy Research Institute (IFPRI). In 2003, Dr. Nankhuni was awarded the T.W. Schultz Prize for best contributed paper to the 25th International Association of Agricultural Economists (IAAE) conference and the Gerald T. Gentry award for best graduate student research paper in the School of Agricultural Sciences at the Pennsylvania State University. She was also awarded the David E. Bell Fellowship in Population and Development Studies from Harvard University in 2005. Before her doctoral studies she was a Lecturer in Economics at the University of Malawi. Currently, she is in-country Director of the Feed the Future Innovation Lab for Food Security Policy (FSP) in Malawi, the New Alliance Policy Acceleration Support: Malawi (NAPAS:Malawi) project, under which she is a Senior Policy Advisor, based in the headquarters of the Ministry of Agriculture, Irrigation, and Water Development of the Government of Malawi.



OCHIENG, DENNIS (IFPRI)

Dennis received his PhD in Agricultural Economics from Georg-August University of Goettingen, Germany and holds a Masters in Agricultural and Applied Economics from Egerton University/ University of Pretoria. His research interests are in global agri-food systems transformation and its implications in the small farm sector in developing countries. Prior to joining IFPRI, he was food security programme manager, implementing SORUDEV/ZEAT-BEAD projects in South Sudan on linking farmers to input and output markets and strengthening their resilience in post-conflict contexts. He has worked with CIAT and UNWFP (P4P pilot) on similar themes in Africa, Asia and Central America.



OMAMO, STEVEN WERE (WFP)

Dr Omamo is the Coordinator of Food Systems Strategy, Policy and Support and Deputy Director of Policy and Programme at the UN World Food Programme (WFP). Since joining WFP in 2006, he has served as Chief of Social Protection and Livelihoods, Chief of Food Security and Safety Nets, Deputy Director of Policy, Planning and Strategy, and Director of WFP Office and Representative to the African Union and UN Economic Commission for Africa, based in

KEYNOTE SPEAKERS

Addis Ababa. He also served as Director of Global Engagement and Research with the International Fund for Agricultural Development (IFAD), Director of Policy and Advocacy with the Alliance for a Green Revolution in Africa (AGRA), Senior Research Fellow and Coordinator of the Eastern Africa Food Policy Network with the International Food Policy Research Institute (IFPRI), Research Officer with the International Service for National Agricultural Research, Research Scientist with the International Livestock Research Institute (ILRI), Technical Advisor with both the Kenya Agricultural Research Institute (KARI) and the Association for Strengthening Agricultural Research in Eastern and Central Africa (ASARECA), and Lecturer at Egerton University, Kenya. Dr Omamo holds a BSc in Agribusiness from California State University, Fresno, an MSc in Agricultural Economics from the University of Connecticut, an MA in International Development Policy and a PhD in Agricultural Economics from Stanford University.



PALM-FORSTER, LEAH H. (University of Delaware)

Leah is an assistant professor at the University of Delaware in the Department of Applied Economics and Statistics. As an environmental and resource economist, Leah is particularly interested in how working agricultural lands can be managed to simultaneously produce market and non-market goods and services. For her Ph.D. dissertation, from Michigan State University's Agricultural, Food, & Resource Economics Department (2015), she identified cost-effective conservation programs using experimental and real auctions that promote coordinated management of row crop systems to enhance aquatic ecosystem services while maintaining farmer profitability. Leah graduated with dual Bachelors in Animal & Poultry Science and Agricultural & Applied Economics (2009) as well as a Masters in Agricultural & Applied Economics (2011) from Virginia Tech.



PARDEY, PHILIP (University of Minnesota)

Philip G. Pardey is professor of science and technology policy in the Department of Applied Economics at the University of Minnesota. He is also the Director of Global Research Strategy for the College of Food Agricultural and Natural Resource Sciences and the Minnesota Agricultural Experiment Station and directs the University's International Science and Technology Practice and Policy (InSTePP) center. Previously he was a senior research fellow at the International Food Policy Research Institute, Washington D.C., and prior to 1994

KEYNOTE SPEAKERS

at the International Service for National Agricultural Research in The Hague, Netherlands. His research deals with productivity measurement and assessment, the finance and conduct of R&D globally, methods for assessing the economic impacts of research, and the economic and policy (especially intellectual property) aspects of genetic resources and the biosciences. Pardey is author of more than 300 books, articles, and papers, including, *Ending Hunger in Our Lifetime: Food Security and Globalization* (Johns Hopkins University Press, 2003), *Saving Seeds: The Economics of Conserving Crop Genetic Resources Ex Situ in the Future Harvest Centers of the CGIAR* (CAB International 2004), *Agricultural R&D in the Developing World: Too Little, Too Late?* (International Food Policy Research Institute, 2006), and *Persistence Pays: U.S. Agricultural Productivity Growth and the Benefits from Public R&D Spending* (Springer 2010).



PINGALI, PRABHU (Cornell University)

Prabhu Pingali is a professor in the Charles H. Dyson School of Applied Economics and Management at Cornell University, with a joint appointment in the Division of Nutritional Sciences, and the Founding Director of the Tata-Cornell Institute for Agriculture and Nutrition (TCI). Prior to joining Cornell, he was the Deputy Director of the Agricultural Development Division of the Bill & Melinda Gates Foundation, from 2008 to May 2013. Pingali was elected to the US National Academy of Sciences in 2007. He is also a Fellow of the American Association of Agricultural Economists. He has over three decades of experience working with some of the leading international agricultural development organizations as a research economist, development practitioner, and senior manager. He has written ten books and over 100 refereed journal articles and book chapters on food policy.



PINSTRUP-ANDERSEN, PER (Cornell University)

Per Pinstrup-Andersen, currently Professor Emeritus and Professor of the Graduate School, was most recently the H. E. Babcock Professor of Food, Nutrition and Public Policy, the J. Thomas Clark Professor of Entrepreneurship, and Professor of Applied Economics at Cornell University and Adjunct Professor, Copenhagen University. He has a B.S. from the Danish Agricultural University, a M.S. and Ph.D. from Oklahoma State University and honorary doctoral degrees from universities in the United States, United Kingdom, Netherlands, Switzerland, and India. He served 10 years as the International Food

KEYNOTE SPEAKERS

Policy Research Institute's Director General and seven years as department head; seven years as an economist at the International Center for Tropical Agriculture, Colombia; and six years as a distinguished professor at Wageningen University. He is the 2001 World Food Prize Laureate and the recipient of several awards for his teaching, research and communication. His recent publications include "The African Food System and its Interaction with Human Health and Nutrition" and "Food Policy for Developing Countries" (Cornell University Press, 2010 and 2011, respectively), co-authored with Derrill Watson. He recently edited a book entitled "Food Price Policy in an Era of Market Instability: A Political Economy Analysis," which will be published by Oxford University Press.



RAMANKUTTY, NAVIN (University of British Columbia)

Navin is Professor and Canada Research Chair in Global Environmental Change and Food Security at the School of Public Policy and Global Affairs and the Institute for Resources, Environment, and Sustainability at the University of British Columbia. His research uses global Earth observations, geospatial analysis and ecosystem models to understand how humans use and modify the Earth's land surface for agriculture, evaluate the global environment consequences, and explore solutions to the problem of feeding humanity with minimal global environmental footprint. He was a lead author of the Millennium Ecosystem Assessment report, and a contributing author of the Fourth Assessment Report of the Intergovernmental Panel on Climate Change.



RICKARD, BRAD (Cornell University)

Brad Rickard is the Ruth and William Morgan Associate Professor of Applied Economics and Management. His teaching and research focus on the economic implications of policies, innovation, and industry-led initiatives in food and beverage markets. Professor Rickard is currently writing a book titled "Agricultural Policy and Global Food Markets" that will be published by Routledge in 2018. Professor Rickard's research program examines issues at the intersection of agricultural markets, food policy, and international trade. His research has assessed how markets for specialty crops respond to changes in nutrition and health information, food labelling practices, promotional efforts, agricultural policy reform, trade liberalization, and the introduction of new technologies. Current work is studying the economics of food waste and the effects of policy initiatives that might be used to mitigate food waste.

KEYNOTE SPEAKERS



SWINNEN, JO (KU Leuven)

Johan Swinnen is a Professor in Development Economics and Director of LICOS Center for Institutions and Economic Performance at the KU Leuven. From 2003 to 2004 he was Lead Economist at the World Bank and from 1998 to 2001 Economic Advisor at the European Commission. He has been advisor to many international institutions and governments. His research focuses on institutional reform and development, globalization and international integration, media economics, and agriculture and food policy. His latest books are "Global Supply Chains, Standards, and the Poor" and "From Marx and Mao to the Market". He has been a guest editor for World Development, Development Policy Review, The World Economy, the European Review of Agricultural Economics, and is associate editor of the American Journal of Agricultural Economics. He is also a senior research fellow at the Centre for European Policy Studies (CEPS), Brussels; coordinator of the European Network of Agricultural and Rural Policy Research Institutes (ENARPRI); member of the Advisory Committee of the Regoverning Markets Global Project; and of the Programme Committee of the International Agricultural Trade Research Consortium (IATRC). He holds a Ph.D. from Cornell University.



TAKESHIMA, HIROYUKI (IFPRI)

Hiroyuki Takeshima joined IFPRI in January 2009 as a postdoctoral fellow of IFPRI Nigeria office, and joined IFPRI Washington office as a research fellow in 2012. Hiroyuki has conducted research on market participation, transaction costs, agricultural technology adoption, biodiversity, and political economy of seed policies in sub-Saharan Africa. His recent research also focuses on the linkages between market and climatic risks and farmers' investment, roles of modern production technologies such as irrigation, mechanisation, and fertiliser on agricultural transformation in sub-Saharan Africa. Hiroyuki earned his PhD from Agricultural and Consumer Economics from University of Illinois, Urbana-Champaign in 2008. Hiroyuki is a citizen of Japan.

KEYNOTE SPEAKERS



VAN CAMPENHOUT, BJORN (IFPRI)

Bjorn Van Campenhout obtained his PhD in Economics from the Catholic University of Leuven (KU Leuven) in 2009. During his PhD, he was employed as a Research Assistant at the Institute for Development Policy and Management (IOB) of the University of Antwerp. He has taught econometrics at University of Antwerp and has been working as a post-doctoral fellow at the KU Leuven (LICOS). Prior to his PhD, he worked as a researcher in various academic positions at different Universities. He also worked as a methodological advisor to a local NGO in Tanzania. Furthermore, he worked as a researcher at the Economic and Social Research Foundation (ESRF) in Dar es Salaam, Tanzania.



VAN EENENNAAM, ALISON (University of California, Davis)

Dr Alison Van Eenennaam is an Animal Genomics and Biotechnology Cooperative Extension Specialist in the Department of Animal Science at the University of California, Davis. Her publicly-funded research and outreach program focuses on the use of animal genomics and biotechnology in livestock production systems. Her current research projects include the development of genomic approaches to select for cattle that are less susceptible to disease, and applied uses of DNA-based information on commercial beef cattle operations. She also has a keen interest in making publicly-accessible educational materials and uses a variety of media to inform general public audiences about science and technology. She has provided a credentialed voice on some controversial topics including cloning and genetically engineered animals. She earned her B.S. from the University of Melbourne in Australia, and both her M.S. and Ph.D. degrees were earned from the University of California, Davis, in animal science and genetics, respectively.



VINK, NICK (Stellenbosch University)

Nick is Chair of the Department of Agricultural Economics at Stellenbosch University and is Editor of the African Journal of Agricultural and Resource Economics, and a past president of the African Association. He serves as a non-Executive Director on the Boards of the South African Reserve Bank, and of Rooibos, Ltd. Nick's main research interests include agricultural development on the African continent, land reform and structural change in South African agriculture, agricultural policy and wine economics.

KEYNOTE SPEAKERS



VON BRAUN, JOACHIM (University of Bonn)

Joachim is an economist, with a Doctoral degree in agricultural economics from University of Göttingen, Germany. He joined ZEF as Professor and Director of the Department for Economic and Technological Change in December 2009. He was also Director of ZEF during its foundation phase 1997-2002. From 2002 to 2009 he was Director General of the International Food Policy Research Institute (IFPRI) based in Washington, DC, U.S.A. His research addresses international and development economics topics, incl. markets and trade; poverty; health and nutrition; agriculture, and science and technology. Among awards received by von Braun are an honorary Doctoral degree from University of Hohenheim, and the Bertebos Prize of the Swedish Academy of Agricultural Sciences for his research on food security, and the Justus von Liebig Prize for his research on international nutrition.



VON CRAMON-TAUBADEL, STEPHAN (University of Göttingen)

Stephan has held the Chair for Agricultural Policy at the University of Göttingen since 1999. He studied agricultural economics at McGill University (BSc) and the University of Manitoba (MSc) in Canada, and completed his PhD at the University of Kiel in Germany. He was editor of Agricultural Economics, the official journal of the IAAE from 2000 to 2006, and has been Secretary-Treasurer of the IAAE since 2015. His research focuses on the analysis of agricultural policies and the empirical study of price transmission and market integration. He is currently involved in research projects in Chile, China, Georgia and India, and he coordinates joint MSc programs between his university and partners in Chile (Universidad de Talca) and Indonesia (Institut Pertanian Bogor).

KEYNOTE SPEAKERS



WINTERS, PAUL (IFAD)

Paul is the Associate Vice-President of the Strategy and Knowledge Department at the International Fund for Agricultural Development (IFAD). Previously he was the Director of Research and Impact Assessment (RIA). From 2004-2015, Winters was a professor in the Department of Economics at American University in Washington, DC where he taught courses on impact evaluation, development economics and environmental economics. Before American University, he worked at the Inter-American Development Bank, the University of New England, and the International Potato Center. He has published numerous journal articles in the areas of impact evaluation, migration, cash transfer programs, rural development and smallholder agriculture. Winters holds a Ph.D. in Agricultural and Resource Economics from the University of California at Berkeley, an M.A. in Economics from the University of California at San Diego and a B.A. in Non-Western Studies from the University of San Diego.

The Department of Agricultural and Resource Economics at the University of Saskatchewan is proud to support ICAE2018.

We have a strong history of research excellence and our internationally recognized faculty are committed to preparing the next generation of leaders in Agricultural Economics.

We are currently recruiting a tenure track faculty position in Agricultural or Regional Economics. To learn more about our innovative programs and this position, please visit agbio.usask.ca/departments/agricultural-and-resource-economics.php



UNIVERSITY OF SASKATCHEWAN
College of Agriculture
and Bioresources

DEPARTMENT OF AGRICULTURAL
AND RESOURCE ECONOMICS
AGBIO.USASK.CA

SCIENTIFIC PROGRAMME

Pre-Conference Workshops

SATURDAY JULY 28

08:30 - 17:00

Workshop	Annual Meeting of the Canadian Agricultural Economics Society
Organizer	Peter Boxall, CAES President
Room	Salon 1

08:30 - 17:00

Workshop	Rural transformation in the 21st Century: The challenges of low-income, late-transforming countries
Organizer	Karen Brooks, IFPRI
Room	Salon 2

08:30 - 17:00

Workshop	Advancing research on nutrition and agriculture
Organizer	Derek Headey, IFPRI
Room	Cypress 2

08:30 - 17:00

Workshop	Quantitative food systems analysis
Organizer	Stephen Were Omamo, WFP
Room	Cypress 1

08:30 - 17:00

Workshop	20 years of value chain research: what have we (not) learned?
Organizer	Jo Swinnen, KU Leuven
Room	Mackenzie

08:30 - 15:30

Workshop	Global Club of Agricultural Economics Administrators
Organizer	Mary Bohman, ERS
Room	Seymour

16:00 - 17:00

Room	Global Club Private Meeting Seymour
-------------	---

SCIENTIFIC PROGRAMME

SUNDAY JULY 29

08:30 - 08:45	PLENARY 1 Welcome and Opening Session Room: Grand Ballroom Ceremonial Opening Chair: Ryan Cardwell, Chair: Local Organizing Committee Welcome Addresses: <ol style="list-style-type: none"> Chris Forbes, Deputy Minister, AAFC Nick Vink, Programme Chair Will Martin, IAAE President 	
08:45 - 10:30	Formal Opening Chair: Jo Swinnen, KU Leuven Presidential Address: Will Martin, IAAE President Elmhirst Memorial Address: Dave Donaldson, MIT: Comparative advantage and agricultural trade	
10:30 - 11:00	Refreshment Break Bayshore Grand Foyer & Stanley Park Foyer	
11:00 - 13:00	INVITED PANELS SESSION 1	
11:00 - 13:00	Invited Panel 1	New approaches to economic geography and trade
	Room	Ballroom ABC
	Convenor	Will Martin, IFPRI
	Format	Presentations
	Papers	<ol style="list-style-type: none"> Dave Donaldson and Treb Allen, MIT: Geography and path dependence Obie Porteous, Middlebury College. Trade and agricultural technology adoption: Evidence from Africa Sebastian Sotelo, University of Michigan: Domestic trade frictions and agriculture

SCIENTIFIC PROGRAMME

SUNDAY JULY 29

11:00 - 13:00	Invited Panel 2	Economics of next generation innovations in food and agriculture
	Room	Ballroom D
	Convenor	Joachim von Braun, University of Bonn
	Format	Panel Discussion
	Panelists	<ol style="list-style-type: none"> Ousmane Badiane, IFPRI: Agricultural policy innovations in Africa Marshall Burke, Stanford University: Innovations in using satellites for measurement of agricultural productivity, environmental change, and poverty in Africa Maximo Torero, The World Bank: Economics of IT-connectivity, rural change, and youth Ashok Gulati, ICRIER, New Delhi: The economics of next innovations in Indian food and agriculture Pinstrup-Andersen, Prof. Emeritus, Cornell University and Adjunct Professor, Copenhagen University: Vertical indoor farming for improved diets: Is the economics right? Regina Birner, University of Hohenheim: Governance and economics of mechanizing Africa's smallholder agriculture
	Moderator	Joachim von Braun, University of Bonn
11:00 - 13:00	Invited Panel 3	Food waste: Insights from recent research and policy perspectives
	Room	Ballroom E
	Convenor	Brad Rickard, Cornell University
	Format	Panel Discussion

SCIENTIFIC PROGRAMME

SUNDAY JULY 29

	Panelists	<ol style="list-style-type: none"> Norbert Wilson, Tufts University Marc Bellemare, University of Minnesota Brenna Ellison, University of Illinois Urbana-Champaign Jacob Ricker-Gilbert, Purdue University
	Moderator	Brad Rickard, Cornell University
11:00 - 13:00	Invited Panel 4	Migration and rural transformation
	Room	Ballroom F
	Convenor	Karen Brooks, IFPRI
	Format	Presentations
	Papers	<ol style="list-style-type: none"> Alan de Brauw, IFPRI: Characterizing rural emigration by youth: Evidence from panel surveys Katrina Kosec, IFPRI: The effects of household income shocks on migration and employment Vanya Slavchevska, FAO: Male out-migration and women's work and empowerment in agriculture: The cases of Nepal and Senegal Cheryl Doss, Oxford: Gender, rural youth, and structural transformation
11:00 - 13:00	Invited Panel 5	Responding to new mandates in consumer and producer decision-making: Insights from behavioral & experimental economics
	Room	Salon 1
	Convenor	Leah H. Palm-Forster, University of Delaware
	Format	Panel Discussion

SCIENTIFIC PROGRAMME

SUNDAY JULY 29

	Panelists	<ol style="list-style-type: none"> Simanti Banerjee, University of Nebraska - Lincoln: Designing agri-environmental programs to enhance provision of landscape-scale ecosystem services Maik Kecinski, University of Alberta: Mitigating stigma to promote the use of non-traditional water Leah H. Palm-Forster, University of Delaware: Perceptions of seed fraud and investment in hybrid maize seed in Kenya Nadia A. Streletskaia, Oregon State University: Unpacking consumer preferences in the presence of certification standards information
	Discussion Facilitator	Leah H. Palm-Forster, University of Delaware
13:00 - 14:00	Lunch Bayshore Grand Foyer & Stanley Park Foyer	
14:00 - 16:00	PARALLEL SESSIONS 1	
	OC = Oral Contributed Paper OS = Organized Symposium VC = Visual Contributed Paper <i>Detailed information (speaker names and paper titles) about OCs and VCs is available in the online conference calendar at https://cslide.ctimeetingtech.com/icae2018/attendee/confcal/session/calendar</i>	
ROOM	SESSION TYPE	SESSION
Ballroom ABC	OC	Technology adoption
Ballroom D	OC	Climate change
Ballroom E	OC	Gender
Ballroom F	OC	Policy analysis
Salon 1	OC	Environmental economics
Salon 2	OC	Trade

SCIENTIFIC PROGRAMME

SUNDAY JULY 29

ROOM	SESSION TYPE	SESSION
Salon 3	OC	Labour
MacKenzie	OC	Nutrition
Seymour	OC	Conservation agriculture
Cypress 1	OC	Finance
Cypress 2	OC	Water resources
Marine	OC	The regulatory environment
Oak 1	OS	26 - 40 years' reform and development in China's agriculture: Lessons and perspectives ORGANIZER: Funing Zhong PARTICIPANTS: Rozelle, Huang, Chen, Zhu, Yu
Oak 2	OS	50 - What can we learn from high-frequency price data for agricultural commodities? ORGANIZER: Joseph Janzen PARTICIPANTS: Julieta Frank, Eleni Gousgounis, Zhepeng Hu, Mindy L. Mallory
Chairman	OS	191 - How are changing land dynamics affecting smallholder participation in agricultural input and output markets in Africa ORGANIZER: Thomas Jayne PARTICIPANTS: Burke, Muyanga, van der Westhuizen
Thompson	OS	92 - Global to local to global modelling of land use change and leakage - perspectives and challenges ORGANIZER: Jan Borner, Tom Hertel PARTICIPANTS: Thomas Heckeley, Jing Liu, Navin Ramankutty
Fraser	OS	141 - Microeconomic impacts of international trade policy ORGANIZER: Anna Josephson PARTICIPANTS: Sylvanus Kwaku Afesorgbor, Rick Barichello, Brady Deaton, Getu Hailu, William Kerr, Jeffery Michler, Natalia Piedrahita, Peter Slade, Franziska Schuenemann

SCIENTIFIC PROGRAMME

SUNDAY JULY 29

ROOM	SESSION TYPE	SESSION
President	OS	115 - Assessing the impact of agricultural projects in Latin America and the Caribbean ORGANIZER: Lina Salazar PARTICIPANTS: Sebastien Gachot, Marcos Agurto, Cesar Lopez
Coquitlam	VC	Climate change
Cowichan	VC	Technology
Fir	VC	Trade
Arbutus	VC	Gender
16:00 - 16:30	Refreshment Break Bayshore Grand Foyer & Stanley Park Foyer	
16:30 - 18:30	PARALLEL SESSIONS 2	
<p>OC = Oral Contributed Paper OS = Organized Symposium VC = Visual Contributed Paper</p> <p><i>Detailed information (speaker names and paper titles) about OCs and VCs is available in the online conference calendar at https://cslide.ctimeetingtech.com/icae2018/attendee/confcal/session/calendar</i></p>		
ROOM	SESSION TYPE	SESSION
Ballroom ABC	OC	Industrial organization
Ballroom D	OC	Technology adoption
Ballroom E	OC	Price analysis
Ballroom F	OC	Technology
Salon 1	OC	Farm management
Salon 2	OC	Human capital
Salon 3	OC	Energy
MacKenzie	OC	Nutrition
Seymour	OC	Migration
Cypress 1	OC	Land resources
Cypress 2	OC	Policy analysis

SCIENTIFIC PROGRAMME

SUNDAY JULY 29

ROOM	SESSION TYPE	SESSION
Marine	OC	Environmental economics
Oak 1	OS	58 - Innovation and supply chain design ORGANIZER: David Zilberman PARTICIPANTS: Geneviève Nguyen, Decio Zylbersztajn, Liang Lu, Madhu Khanna PANELISTS: Madhu Khanna, Claude Ménard, Thomas Reardon, David Zilberman, Decio Zylbersztajn
Oak 2	OS	135 - Renewable energy and agriculture ORGANIZER: Channing Arndt PARTICIPANTS: Tom Hertel, Wallace Tyner
Chairman	OS	103 - American food choices: New insights from the National Household Food Acquisition and Purchase Survey (FoodAPS) ORGANIZER: Elina Page, Lisa Mancino, Mark Denbaly PARTICIPANTS: Elizabeth Larimore, Xingyou Zhang, Shelly Ver Ploeg
Thompson	OS	113 - China's Belt & Road Initiative and international agricultural development ORGANIZER: Xiaohua Yu PARTICIPANTS: Awudu Abdulai, Stephan von Cramon-Taubadel, Huanguang Qiu, Jing You, Xiaohua Yu, Shi Zheng
Fraser	OS	177 - IPRs and incentives for private plant breeding - theory and practice ORGANIZER: Richard Gray PARTICIPANTS: Harvey Brooks, Derek Brewin, Terence Farrell, Kostas Karantininis, Stephane Lamarie, Giancarlo Moschini
President	OS	153 - The development of the soybean industry in Southern and Eastern Africa ORGANIZER: Julian Binfield PARTICIPANTS: Tracy Davids, Richard Kachule, Brian Chisanga

SCIENTIFIC PROGRAMME

SUNDAY JULY 29

ROOM	SESSION TYPE	SESSION
Coquitlam	VC	Food security
Cowichan	VC	Finance
Fir	VC	Farm management
Arbutus	VC	Conservation
18:30 - 19:30		IAAE Business Meeting Salon 1
19:30 - 21:00		Welcome and Opening Reception Bayshore Grand Foyer, Currents & Pool Garden Area

MONDAY JULY 30

08:00 - 10:00	PLENARY 2 Agricultural technology – The data revolution Room: Grand Ballroom Moderator: Julian Alston, University of California, Davis Presentations 1. Alison van Eenennaam, University of California, Davis: Mining and manipulating agricultural genes 2. Vipin Kumar, University of Minnesota: Remote sensing and machine learning for natural and agricultural landscapes 3. Philip Pardey, University of Minnesota: Beyond Big Data to actionable information in agriculture 4. Gero Carletto, World Bank: Socioeconomic data - lessons from LSMS
10:00 - 10:30	Refreshment Break Bayshore Grand Foyer & Stanley Park Foyer

SCIENTIFIC PROGRAMME

MONDAY JULY 30

10:30 - 12:30	INVITED PANELS SESSION 2	
10:30 - 12:30	Invited Panel 6	Science and policy communication for food and agriculture
	Room	Ballroom ABC
	Convenor	Julian Alston, University of California, Davis Phil Pardey, University of Minnesota
	Format	Panel Discussion
	Panelists	<ol style="list-style-type: none"> Alison Van Eenennaam, University of California, Davis: Communicating science in a networked World Daniel Sumner, University of California, Davis: Food nonsense: Lessons from failures in communicating sensible economics of agriculture Jo Swinnnen, KU Leuven: Rationally ignorant voters and consumers and food policy in the 21st century: Twitter and social media storm
	Moderator	4. Per Pinstrup-Anderson, Cornell University
10:30 - 12:30	Invited Panel 7	Emerging issues in livestock economics
	Room	Ballroom D
	Convenor	Alejandro Acosta, FAO
	Format	Presentations
	Papers	<ol style="list-style-type: none"> Luis De los Santos, Gottingen University: What is driving the change? A Total Factor Productivity analysis of livestock production Francesco Nicolli, European University Institute: Are livestock's keepers more resilient to climate shocks: Fact or artifact? Alejandro Acosta, FAO: The effects of animal disease outbreaks on food price dynamics: The case of H7N3 in the Mexican egg market

SCIENTIFIC PROGRAMME

MONDAY JULY 30

10:30 - 12:30	Invited Panel 8	Making agrarian transformation work for smallholders in Asia: Imperatives for policy research
	Room	Ballroom E
	Convenor	Avinash Kishore, IFPRI
	Format	Presentations
	Papers	<ol style="list-style-type: none"> Session Chair: Prabhu Pingali, Cornell University: The nutrition challenge for the agrarian transformation: The key entry points within agriculture and food systems to integrate nutritional objectives? Madhur Gautam, World Bank, South-South Learning: How can countries of Asia and Africa learn from experience of each other in policy and institutional innovations? Peter Hazell, Independent Researcher, Policies and institutional arrangements can make agriculture less resource intensive and more environmentally friendly in Asia PK Joshi, IFPRI: Policies and institutional innovations will help integrate smallholders into local, regional and global value-chains?
	Discussion Facilitator	Shahidur Rashid, IFPRI

SCIENTIFIC PROGRAMME

MONDAY JULY 30

10:30 - 12:30	Invited Panel 9	Agriculture and the WTO
	Room	Ballroom F
	Convenors	Joe Glauber, WTO Will Martin, IFPRI
	Format	Presentations
	Papers	<ol style="list-style-type: none"> 1. Joe Glauber: Overview on trade policy 2. Dan Summer, Frank H. Buck: The economics of dispute resolution at the WTO 3. Jonathan Brooks: Outlook for agricultural trade and policy 4. Edwini Kessie: The current state of trade negotiations at the WTO
	Moderator	Rob Vos, IFPRI
	Discussant	Ulla Kask, WTO, Will Martin, IFPRI
10:30 - 12:30	Invited Panel 10	Editorial perspectives on Agricultural Economic Journals, Will Martin, IFPRI
	Room	Salon 1
	Convenor	Awudu Abdulai, University of Kiel
	Format	Panel Discussion
	Panelists	<ol style="list-style-type: none"> 1. Tim Beatty, American Journal of Agricultural Economics 2. Marc F. Bellemare, Food Policy 3. Ada Wossink, European Review of Agricultural Economics 4. Travis Lybbert, American Journal of Agricultural Economics 5. Craig Gundersen, Applied Economic Perspectives and Policy
	Moderator	Awudu Abdulai, Agricultural Economics

SCIENTIFIC PROGRAMME

MONDAY JULY 30

10:30 - 12:30	Invited Panel 11	Rural Development Report 2019: Rural Youth. Preview and Feedback to IFAD
	Room	Salon 2
	Convenor	Paul Winters, IFAD
	Format	Panel Discussion
	Panelists	Karen Brooks, IFPRI Cheryl Doss, Oxford Thomas Reardon, Michigan State Guy Stecklov, University of British Columbia
12:30 - 13:30	Lunch Bayshore Grand Foyer & Stanley Park Foyer	
13:30 - 15:30	PARALLEL SESSIONS 3	
<p>OC = Oral Contributed Paper OS = Organized Symposium VC = Visual Contributed Paper</p> <p><i>Detailed information (speaker names and paper titles) about OCs and VCs is available in the online conference calendar at https://cslide.ctimeetingtech.com/icae2018/attendee/confcal/session/calendar</i></p>		
ROOM	SESSION TYPE	SESSION
Ballroom ABC	OC	Technology
Ballroom D	OC	Industrial organization
Ballroom E	OC	Food security
Ballroom F	OC	Food safety
Salon 1	OC	Efficiency
Salon 2	OC	Health
Salon 3	OC	Finance
MacKenzie	OC	Nutrition
Seymour	OC	Climate change
Cypress 1	OC	Water resources
Cypress 2	OC	Data and methods

SCIENTIFIC PROGRAMME

MONDAY JULY 30

ROOM	SESSION TYPE	SESSION
Oak 1	OS	192 - New evidence and approaches for food loss and waste estimates ORGANIZER: William H. Meyers PARTICIPANTS: Alicia English, Carola Fabi, Matteo Vittuari, Marc Bellemare, Anne Byrne, Yanjun Ren
Oak 2	OS	120 - Curse or blessing: The role of GI in stabilizing farm income and trade and ease consumer's choice ORGANIZER: Monika Hartmann PARTICIPANTS: Monika Hartmann (Chair); Filippo Arfini (Presenter); Jose M. Gil (Presenter); Alessandro Olper (Presenter); Ching-Hua Yeh (Presenter); Carola Grebitus (Discussant); Troy Schmitz (Discussant)
Chairman	OS	163 - It can be done. Improving the measurement of agricultural productivity through sustainable innovations ORGANIZER: Alberto Zezza PARTICIPANTS: Talip Kilic, David Lobell, Thomas Daum, Alberto Zezza, Calogero Carletto
Thompson	OS	104 - Economic evaluation of agricultural strategies to improve nutrition and health ORGANIZER: Carol Levin, Will Masters PARTICIPANTS: Steve Vosti, Alan de Brauw
Fraser	OS	101 - Agricultural input subsidy programs in Sub-Saharan Africa: are recent program innovations improving program performance? Evidence from Malawi, Nigeria, & Zambia ORGANIZER: Nicole Mason PARTICIPANTS: Solomon Asfaw, Tahirou Abdoulaye, Nicholas Minot, Rodney Lunduka, Shahidur Rashid, Saweda Liverpool-Tasie

SCIENTIFIC PROGRAMME

MONDAY JULY 30

ROOM	SESSION TYPE	SESSION
President	OS	147 - Productivity growth and emerging regional issues in agricultural development ORGANIZER: Keijiro Otsuka PARTICIPANTS: Futoshi Yamauchi, Anjani Kumar, Thomas Jayne, Jo Swinnen, Ruben G. Echeverria
Coquitlam	VC	Data and methods and price analysis
Cowichan	VC	Technology
Fir	VC	Policy analysis
Arbutus	VC	Resources: Land
15:30 - 16:00	Refreshment Break Bayshore Grand Foyer & Stanley Park Foyer	
16:00 - 17:00	PARALLEL SESSIONS 4	
	OC = Oral Contributed Paper OS = Organized Symposium VC = Visual Contributed Paper <i>Detailed information (speaker names and paper titles) about OCs and VCs is available in the online conference calendar at https://cslide.ctimeetingtech.com/icae2018/attendee/confcal/session/calendar</i>	
ROOM	SESSION TYPE	SESSION
Ballroom ABC	OC	Data and method
Ballroom D	OC	Poverty
Ballroom E	OC	Climate change
Ballroom F	OC	Inequality
Salon 1	OC	GM foods
Salon 2	OC	Institutions
Salon 3	OC	Industrial organizations
MacKenzie	OC	Poverty
Seymour	OC	Farm management

SCIENTIFIC PROGRAMME

MONDAY JULY 30

ROOM	SESSION TYPE	SESSION
Cypress 1	OC	Social capital
Cypress 2	OC	Social capital
Marine	OC	Finance
Oak 1	OC	Farm management
Oak 2	OC	Natural resources
Chairman	OC	Consumption
Thompson	OC	Energy
Fraser	OC	Growth
President	OC	Livestock
17:30 - 19:30	PLENARY 3 The future of food systems in developing countries Room: Grand Ballroom Moderator: Prabhu Pingali, Cornell University Panelists 1. Peter Hazell, Independent consultant: Future of smallholder agriculture 2. Kym Anderson, University of Adelaide: Trade and future food systems 3. Regina Birner, University of Hohenheim: Bioeconomy trends 4. J. Meenakshi, Delhi School of Economics: Nutrition-sensitive food systems	
20:30 - 21:30	Movie Screening - "Food Evolution" Ballroom ABC	

SCIENTIFIC PROGRAMME

TUESDAY JULY 31

08:00 - 10:00	PARALLEL SESSIONS 5	
	OC = Oral Contributed Paper OS = Organized Symposium VC = Visual Contributed Paper <i>Detailed information (speaker names and paper titles) about OCs and VCs is available in the online conference calendar at https://cslide.ctimeetingtech.com/icae2018/attendee/confcal/session/calendar</i>	
ROOM	SESSION TYPE	SESSION
Ballroom ABC	OC	Land reform
Ballroom D	OC	Trade
Ballroom E	OC	Gender
Ballroom F	OC	Farm management
Salon 1	OC	History
Salon 2	OC	Industrial organization
Salon 3	OC	Technology adoption
MacKenzie	OC	Technology
Seymour	OC	Labour
Cypress 1	OC	Efficiency
Cypress 2	OC	Nutrition
Marine	OC	Price transmission
Oak 1	OS	17 - A reassessment of the farm size-productivity debate ORGANIZER: Nicholas Rada PARTICIPANTS: Keith Fuglie, Steven Helfand, Boris Bravo-Ureta, Yu (Eric) Sheng, Madhur Gautam
Oak 2	OS	129 - The future of agricultural policies in the G3 (EU, USA, China) ORGANIZER: Tassos Haniotis, Jo Swinnen PARTICIPANTS: Mary Bohman, David Orden, Jikun Huang

SCIENTIFIC PROGRAMME

TUESDAY JULY 31

ROOM	SESSION TYPE	SESSION
Chairman	OS	81 - Fertilizer subsidy policies in South Asia: Reforms, reversals and consequences ORGANIZER: Shahidur Rashid PARTICIPANTS: Alex E Winter-Nelson, Derek Byerlee, Paul Dorosh, Mainul Hoque, Avinash Kishore, Shahidur Rashid, Jeevika Weeraheva
Thompson	OS	82 - Increasing smallholder farmers' access to quality seeds and traits: Markets, institutions and policy considerations ORGANIZER: Mywish Maredia PARTICIPANTS: Spielman, Travis Lybbert, Gracious Diiro, Guy Hareau, Robert Shupp
Fraser	OS	166 - Sustainable resource use in Chinese agriculture - Challenges and inclusive policy approaches ORGANIZER: Lena Kuhn, Zhanli Sun, Thomas Herzfeld, Liangzhi You PARTICIPANTS: David Abler, Shuyi Feng, Xiaohua Yu, Wei Xie
President	OS	108 - Land rental markets as a pathway into agriculture for youth in Sub-Saharan Africa ORGANIZER: Jordan Chamberlin PARTICIPANTS: Jacob Ricker-Gilbert, Frank Place, Stein Holden, Hosaena Ghebru
Coquitlam	VC	Resources: Capital and water
Cowichan	VC	Consumer choice
Fir	VC	Food safety and health
Arbutus	VC	Household economics and food waste
10:00 - 10:30	Refreshment Break Bayshore Grand Foyer & Stanley Park Foyer	
10:30 - 18:00	Conference Tours Offsite	

SCIENTIFIC PROGRAMME

TUESDAY JULY 31

19:30	Offsite Dinner Vancouver Aquarium
-------	---

WEDNESDAY AUGUST 1

08:30 - 10:30	<p>PLENARY 4 New landscapes and challenges amidst Africa's rapidly transforming food systems Room: Grand Ballroom</p> <p>Moderator: Thom Jayne, Michigan State University</p> <p>Presentations</p> <ol style="list-style-type: none"> 1. Maria Wanzala-Mlobela, African Fertilizer and Agribusiness Partnership; Joshua Ariga, International Fertilizer Development Center; and Edward Mabaya, Cornell University: Can technology still give Africa a Green Revolution? Multi-country analysis of improved seed, fertilizer and allied technology delivery systems 2. Milu Muyanga, Felix Kwame Yeboah, Michigan State University, Antony Chapoto, IAPRI/Zambia, and T.S. Jayne: The role of medium and large farms in driving agri-food systems transformation in Africa <p>Panel Discussion:</p> <p>Panelists</p> <ol style="list-style-type: none"> 1. Ousmane Badiane, International Food Policy Research Institute 2. Edward Mabaya, Cornell University 3. Flora Nankhuni, New Alliance Policy Acceleration Support (NAPAS) 4. Herbert Ainembabazi, Alliance for a Green Revolution in Africa 5. John Mellor, Independent Consultant
10:30 - 11:00	Refreshment Break Bayshore Grand Foyer & Stanley Park Foyer

SCIENTIFIC PROGRAMME

WEDNESDAY AUGUST 1

11:00 - 13:00	PARALLEL SESSIONS 6	
	<p>OC = Oral Contributed Paper OS = Organized Symposium VC = Visual Contributed Paper <i>Detailed information (speaker names and paper titles) about OCs and VCs is available in the online conference calendar at https://slide.citimeetingtech.com/icae2018/attendee/confcal/session/calendar</i></p>	
ROOM	SESSION TYPE	SESSION
Ballroom ABC	OC	Trade
Ballroom D	OC	Price analysis
Ballroom E	OC	Climate change
Ballroom F	OC	Gender
Salon 1	OC	Food safety
Salon 2	OC	Water resources
Salon 3	OC	Environmental economics
MacKenzie	OC	Policy analysis
Seymour	OC	Nutrition
Cypress 1	OC	Finance
Cypress 2	OC	Technology
Marine	OC	Spatial economics
Oak 1	OS	<p>97 - Brexit and future EU and UK agricultural policies: Analysis and views from various quarters ORGANIZER: Sophia Davidova PARTICIPANTS: Julian Binfield, Donnellan, Lorraine Mitchell, Thomson, Shuyi Feng</p>
Oak 2	OS	<p>100 - Global agricultural innovation and R&D: Data, measurement and application ORGANIZER: Michiel van Dijk PARTICIPANTS: Paul Heisey, Alejandro Nin-Pratt, Saeed Moghayer, Michiel van Dijk</p>

SCIENTIFIC PROGRAMME

WEDNESDAY AUGUST 1

ROOM	SESSION TYPE	SESSION
Chairman	OS	<p>138 - Advances in nonlinear time series analysis ORGANIZER: Ford Ramsey PARTICIPANTS: Julieta Frank, Matt Holt, Alan Ker, Bruno Larue, Xun Lu</p>
Thompson	OS	<p>98 - Decision-making within agricultural households: New concepts, empirical approaches and outcomes ORGANIZER: Veronique Theriault, Cheryl Doss PARTICIPANTS: Jennifer Twyman, Melinda Smale, Diksha Arora, Dorene Asare-Marfo</p>
Fraser	OS	<p>105 - Food security and commodity storage ORGANIZER: Gerrit Cornelis van Kooten PARTICIPANTS: Justus Wesseler, Gebreegzabher, Lynn Kennedy, Troy Schmitz</p>
President	OS	<p>121 - Experiments to increase smallholder farmer demand for weather index insurance ORGANIZER: Sarah Janzen PARTICIPANTS: Steve Boucher, Michael Carter, Jon Einar Flatnes, Sarah Janzen, Harounan Kazianga, Berber Kremer, Simrin Makhija, Khushbu Mishra, Conner Mullally</p>
Coquitlam	VC	Nutrition
Cowichan	VC	Migration and spatial economics
Fir	VC	Industrial organization
Arbutus	VC	Cooperatives and contracts
13:00 - 14:00	Lunch	Bayshore Grand Foyer & Stanley Park Foyer

SCIENTIFIC PROGRAMME

WEDNESDAY AUGUST 1

14:00 - 16:00	PLENARY 5 Producing more with less: Agriculture, land use and ecosystems Room: Grand Ballroom Moderator: Stephan von Cramon-Taubadel, University of Göttingen Presentations <ol style="list-style-type: none"> 1. James Gerber, University of Minnesota: Room to grow: Change in yield gaps over time 2. Navin Ramankutty, University of British Columbia: Evaluating the potential of alternative farming systems 3. Sjaak Conijn, Wageningen University and Research: Feeding our world within planetary boundaries? 	
16:00 - 16:30	Refreshment Break Bayshore Grand Foyer & Stanley Park Foyer	
16:30 - 18:30	PARALLEL SESSIONS 7 OC = Oral Contributed Paper OS = Organized Symposium VC = Visual Contributed Paper <i>Detailed information (speaker names and paper titles) about OCs and VCs is available in the online conference calendar at https://slide.cimeetingtech.com/icae2018/attendee/confcal/session/calendar</i>	
ROOM	SESSION TYPE	SESSION
Ballroom ABC	OC	Productivity
Ballroom D	OC	Technology adoption
Ballroom E	OC	Industrial organization
Ballroom F	OC	Efficiency
Salon 1	OC	Household economics
Salon 2	OC	Spatial economics
Salon 3	OC	Finance
MacKenzie	OC	Price analysis
Seymour	OC	Climate change

SCIENTIFIC PROGRAMME

WEDNESDAY AUGUST 1

ROOM	SESSION TYPE	SESSION
Cypress 1	OC	Farm management
Cypress 2	OC	Land resources
Marine	OC	Policy analysis
Oak 1	OS	151 - Positioning agriculture for the SDGs ORGANIZER: Shenggen Fan PARTICIPANTS: Paul Dorosh, Keijiro Otsuka, Thomas Reardon, Will Masters, Frank Place, Cheryl Doss
Oak 2	OS	128 - The role of science in public policy: Public perceptions and regulatory paradigms ORGANIZER: Jill Hobbs PARTICIPANTS: Justus Wesseler, Jutta Roosen, Ellen Goddard, Yang Yang, Helen Jensen
Chairman	OS	74 - The trade impacts of China's agricultural policies ORGANIZER: Mary Marchant, Jing Zhu PARTICIPANTS: Francis Tuan, Funing Zhong, Jing Zhu, James Hansen, Mina Hejazi, Francis Tuan, Agapi Somwaru, David Orden, Lars Brink, Cheng Guoqiang
Thompson	OS	90 - How large are the welfare and health gains to post-harvest interventions? Evidence from randomized control trials in Africa and South Asia. ORGANIZER: Jacob Ricker-Gilbert PARTICIPANTS: Katherine Baylis, Hugo De Groote, Nicholas Magnan, Vivian Hoffmann
Fraser	OS	41 - Coordination of supply chains: How can insights from choice experiments contribute? ORGANIZER: Goedele Van den Broeck, Miet Maertens, Matin Qaim PARTICIPANTS: Bonjean, Eva-Marie Meemken, Ruben, Mara Thiene, Meike Wollni

SCIENTIFIC PROGRAMME

WEDNESDAY AUGUST 1

ROOM	SESSION TYPE	SESSION
President	OS	122 - Gender and climate change analyses in the context of international agricultural policy monitoring ORGANIZER: Will Martin, Carmine Paolo De Salvo PARTICIPANTS: Jonathan Brooks, Federica Angelucci, Pedro Martel, David Laborde, Ruben Flores
Coquitlam	VC	Technology and growth
Cowichan	VC	Labour and poverty
Fir	VC	Energy and pollution
Arbutus	VC	Policy analysis

THURSDAY AUGUST 2

08:30 - 10:30	PLENARY 6 Insights from a behavioural lens: Why perceptions and diversity matter Room: Grand Ballroom Moderator: Jill Hobbs, University of Saskatchewan Presentations <ol style="list-style-type: none"> Vic Adamowicz, University of Alberta: Perceptions in economic models: What do you really think? Jill McCluskey, Washington State University: Why diversity and expectations matter: Theory and evidence Floor discussion
10:30 - 11:00	Refreshment Break Bayshore Grand Foyer & Stanley Park Foyer

SCIENTIFIC PROGRAMME

THURSDAY AUGUST 2

11:00 - 13:00	INVITED PANELS SESSION 3	
11:00 - 13:00	Invited Panel 12	Quality, integrity, ethics and making an impact through Agricultural Economics research
	Room	Ballroom ABC
	Convenor	Martin Banse, Thünen-Institute of Market Analysis
	Format	Panel discussion
	Panelists	<ol style="list-style-type: none"> Ashok Gulati, Indian Council for Research on International Economic Relations Steve Hatfield-Dodds, ABARES Alban Thomas, INRA Carmel Cahill, Trade and Agriculture Directorate, OECD Kim Chang-Gil, Korea Rural Economic Institute Kara Beckles, Research and Analysis Directorate, Agriculture and Agri-Food Canada
	Moderator	Mary Bohman, ERS, USDA

SCIENTIFIC PROGRAMME

THURSDAY AUGUST 2

11:00 - 13:00	Invited Panel 13	Beverage (and substitute) markets and policies
	Room	Ballroom D
	Convenor	Kym Anderson, University of Adelaide and Australian National University
	Format	Presentations
	Papers	<ol style="list-style-type: none"> 1. Kym Anderson, University of Adelaide and Australian National University: Wine globalization: past and prospective 2. Jo Swinnen, KU Leuven and Stanford University: Beer globalization, regulations and the craft beer revolution: Past and prospective 3. Lara Cockx and Giulia Meloni, University of Leuven: The global spirits business: Historical evolution, regulations, and new developments <p>Panel discussion on improving the design of beverage (and marijuana) taxes and regulations</p>
Discussion Opener	Dan Sumner, University of California, Davis	
11:00 - 13:00	Invited Panel 14	The future of work in agriculture
	Room	Ballroom E
	Convenor	Luc Christiaensen, World Bank
	Format	Presentations

SCIENTIFIC PROGRAMME

THURSDAY AUGUST 2

	Speakers	<ol style="list-style-type: none"> 1. Luc Christiaensen, World Bank: Africa's agricultural youth exit and the ageing of the agricultural labor force 2. David Tschirley, Michigan State University: The potential for off-farm employment opportunities in the agricultural value chains 3. Edward Taylor, University of California, Davis: The future for agricultural wage labor immigration 4. Diane Charlton, Montana State University: The labor implications of robotization on and off the fields
	Moderator	Jo Swinnen, KU Leuven
	Invited Panel 15	Food for the future
11:00 - 13:00	Room	Ballroom F
	Convenors	Carola Grebitus, Arizona State and Jerome Dumortier, Indiana University - Purdue University
	Format	Panel Discussion
	Panelists	<ol style="list-style-type: none"> 1. Miguel Carriquiry, Universidad de la República de Uruguay 2. Jerome Dumortier, Indiana University - Purdue University 3. Silke Hüttel, Bonn University 4. Alex Mahalov, Arizona State University 5. Jane Kolodinsky, University of Vermont 6. Navin Ramankutty, University of British Columbia 7. Bodo Steiner, University of Helsinki
	Moderator	Carola Grebitus, Arizona State University

SCIENTIFIC PROGRAMME

THURSDAY AUGUST 2

11:00 - 13:00	Invited Panel 16	Towards more sustainable diets: How food economists' research can contribute
	Room	Salon 1
	Convenors	José M. Gil, CREDA-UPC-IRTA and Advisory Board of EUROCHOICES
	Format	Presentations
	Papers	<ol style="list-style-type: none"> 1. Krijn Poppe, Wageningen University and Research: Food policy needs underpinning with a research infrastructure 2. Jay Variyam, USDA: Assessing transition to healthier American diets 3. Vincent Riquillart, Toulouse School of Economics: Sustainable diets in 5 EU countries: Current situation and impact of alternative policies 4. David R. Just, Anne T. Byrne, Cornell University: Developing evidence of food behavior for policy
	Discussion Openers	Jutta Roosen, Technical University of Munich and President Elect EAAE; Tim Lloyd, Agricultural Economics Society
11:00 - 13:00	Invited Panel 17	Challenges and opportunities for scaling up agricultural innovations: Lessons learned from 15 years of biofortification
	Room	Salon 2
	Convenor	Ekin Birol, HarvestPlus
	Format	Panel Discussion
	Panelists	<ol style="list-style-type: none"> 1. Ekin Birol, HarvestPlus, IFPRI 2. Keith Lividini, HarvestPlus, IFPRI 3. Bho Mudyahoto, HarvestPlus, IFPRI 4. David Spielman, IFPRI
	Moderator	Manfred Zeller, Hohenheim

SCIENTIFIC PROGRAMME

THURSDAY AUGUST 2

13:00 - 14:00	Lunch Bayshore Grand Foyer & Stanley Park Foyer	
14:00 - 15:20	PARALLEL SESSIONS 8	
	OC = Oral Contributed Paper OS = Organized Symposium VC = Visual Contributed Paper <i>Detailed information (speaker names and paper titles) about OCs and VCs is available in the online conference calendar at https://cslide.ctimeetingtech.com/icae2018/attendee/confcal/session/calendar</i>	
ROOM	SESSION TYPE	SESSION
Ballroom ABC	OC	Climate change
Ballroom D	OC	Trade
Ballroom E	OC	Food security
Ballroom F	OC	Industrial organization
Salon 1	OC	Geographic indicators
Salon 2	OC	Growth
Salon 3	OC	Technology adoption
MacKenzie	OC	Human capital
Seymour	OC	Farm management
Cypress 1	OC	Migration
Cypress 2	OC	Nutrition
Marine	OC	Fisheries
Oak 1	OS	59 - Modelling domestic and international impacts of China's grain policy reform scenarios: Insights from four modelling approaches ORGANIZER: Wusheng Yu, Shingo Kimura PARTICIPANTS: Jonathan Brooks, Shingo Kimura, Yumei Zhang, Tianxiang Li

SCIENTIFIC PROGRAMME

THURSDAY AUGUST 2

ROOM	SESSION TYPE	SESSION
Oak 2	OS	<p>63 - International trade, product quality and food standards</p> <p>ORGANIZER: Alessandro Olper, Karine Latouche, Charlotte Emlinger</p> <p>PARTICIPANTS: Bruno Larue, Carl Gaigne</p>
Chairman	OS	<p>160 - Africa's rural youth - An underutilized resource for the transformation of African agriculture</p> <p>ORGANIZER: Heike Baumüller</p> <p>PARTICIPANTS: Joachim von Braun, Oliver Kirui, Tekalign Sakketa, Essa Mussa</p>
Thompson	OS	<p>21 - Mutual accountability: Economic foundations, best practices, and policy implications</p> <p>ORGANIZER: James Oehmke</p> <p>MODERATOR: Ousmane Badiane</p> <p>PRESENTERS (LIGHTNING SESSION): Tsitsi Makombe, Kristin Franklin, Martin Fowler, Greenwell Matchaya, Sheryl Hendriks</p> <p>DISCUSSANT: Godfrey Bahiigwa</p>
15:20 - 15:50	<p>Refreshment Break</p> <p>Bayshore Grand Foyer & Stanley Park Foyer</p>	
15:50 - 18:10	<p>PLENARY 7</p> <p>Upgraded papers</p> <p>Venue: Salon 1, 2, 3</p> <p>Chair: Will Martin, IFPRI</p> <p>Uma Lele Award</p> <p>Presenters:</p> <ol style="list-style-type: none"> 1. Anna Josephson, Purdue University: Share and share alike: The impact of rainfall on gendered income allocation in Malawi 2. Tewodaj Mogues, IFPRI: Cost-effectiveness of community-based gendered advisory services to farmers: Analysis in Mozambique and Tanzania 3. Bjorn van Campenhout, IFPRI: The role of gender in ICT-mediated agricultural information campaigns 	

SCIENTIFIC PROGRAMME

THURSDAY AUGUST 2

	<p>Nils Westermark Award</p> <p>Presenters:</p> <ol style="list-style-type: none"> 1. Caitlin Herrington, HarvestPlus, J. Funes, K. Lividini, M. Moursi, V. Taleon, D. Asare-Marfo, E. Birol: Subnational prioritization for biofortification interventions in Nigeria 2. Dennis Ochieng, IFPRI: Supermarket contracts, income, and changing diets of farm households: panel data evidence from Kenya 3. Hiroyuki Takeshima, IFPRI: The roles of agroclimatic similarity and returns to scale in the demand for mechanization: insights from northern Nigeria
	<p>TW Schultz Award</p> <p>Presenters:</p> <ol style="list-style-type: none"> 1. Alain Carpentier, Philippe Koutchadé, INRA SMART-LERECO, Fabienne Féménia, UMR SMART-LERECO, INRA: Dealing with corner solutions in multi-crop micro-econometric models: an endogenous regime approach with regime fixed costs 2. Kohei Hayashida, University of Tokyo: Bargaining power between food processors and retailers: Evidence from Japanese milk transactions 3. Berber Kramer and Francisco Ceballos, IFPRI: Enhancing adaptive capacity through climate-smart insurance: Theory and evidence from India
18:10 - 18:30	<p>CLOSING CEREMONY</p> <p>Room: Salon 1, 2, 3</p> <p>Chair: Will Martin (Outgoing President)</p>
19:30	<p>Conference Dinner</p> <p>Bayshore Grand Ballroom</p>

NOTES



**30th INTERNATIONAL CONFERENCE OF
AGRICULTURAL ECONOMISTS**

JULY 28 - AUGUST 2
VANCOUVER, CANADA